

TELEP2

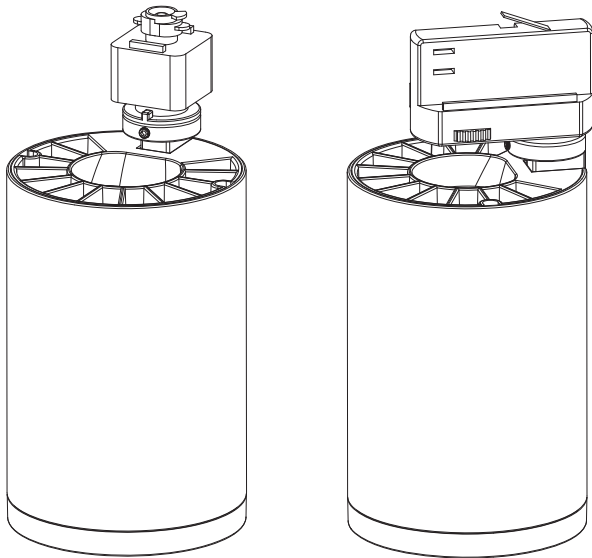

INSTRUCTION MANUAL

SERIES: TELEP2

Read these instructions completely and carefully.

⚠ ATTENTIONS

Read the instruction carefully before installation , non-observance of this instruction may cause damage to the fixture or hurt to human body. The installation must be carried out by a qualified electrician in accordance with local or national codes.
Cut off the power supply before installation and maintenance !

Regularly check the light source , the LED power supply, the cord and other accessories. If any part is damaged, the product should not be used.

Keep this instruction manual handy for future use.

The light source of these products are non-changeable light diodes(LED).
Do not disassemble the product, as the light diode can cause damage to the eyes.
Use only in indoor,dry location.Clean the product with a dry cloth.

Lighting installation at a height of 2.5 meters above.

Dimensions: (inch/mm)

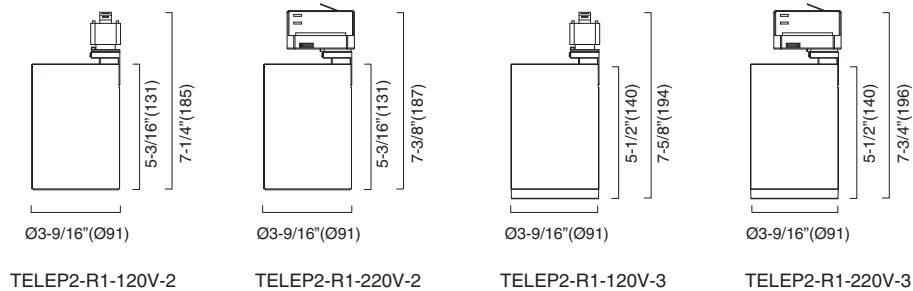

Specifications :

	Model	Rated input	Power	ta
US	TELEP2-R1-120V-2	120VAC	32W	-20°C~35°C (-4~95°F)
	TELEP2-R1-120V-3	120VAC		
EU	TELEP2-R1-220V-2	220~240VAC	30W	-20°C~35°C (-4~95°F)
	TELEP2-R1-220V-3	220~240VAC		

Tools



Electrical Safety Gloves



Clean cloth



Cleaning liquid
(50% ethanol)



Suction lifter

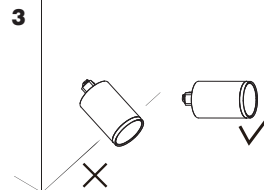
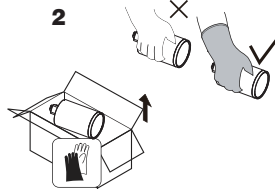
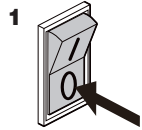

Installation(US)

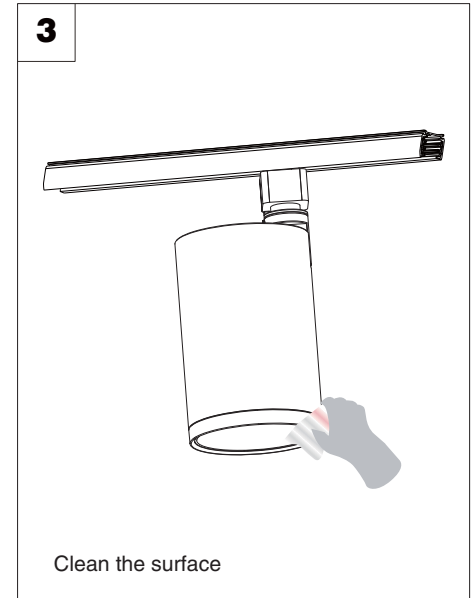
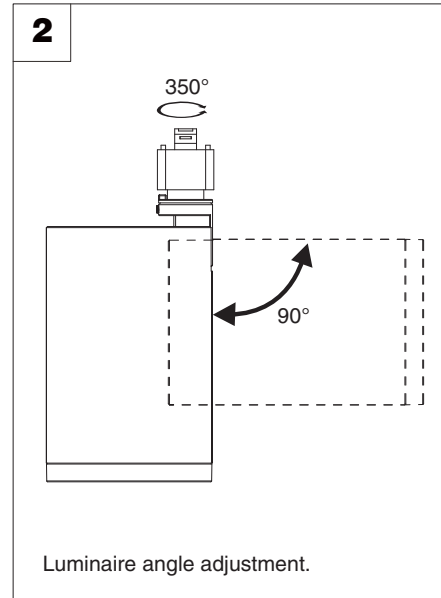
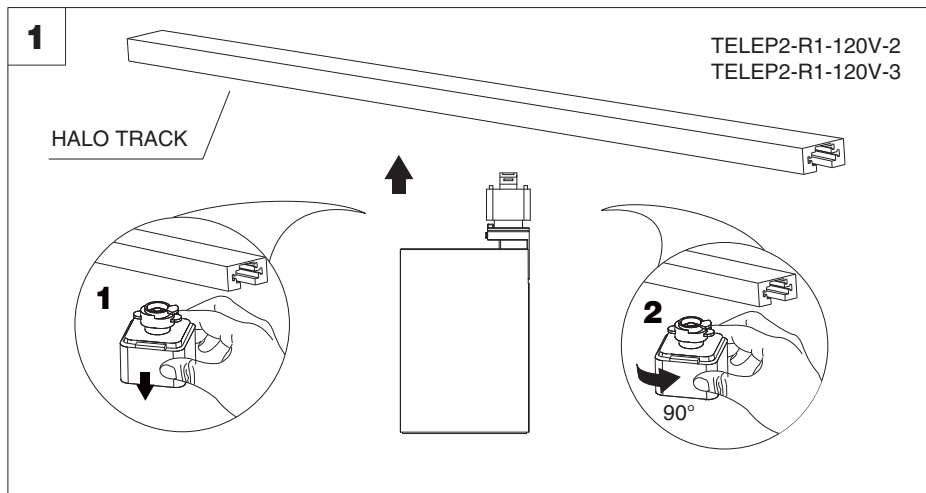

Installation(EU)

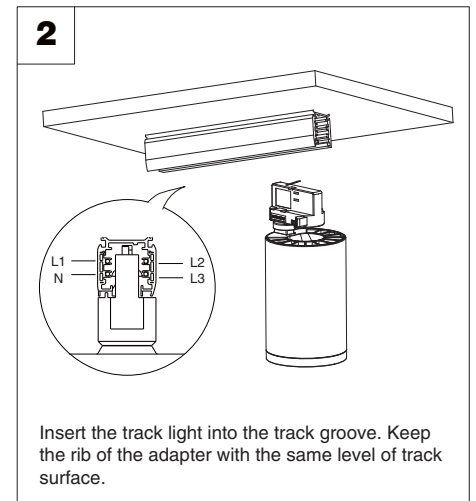
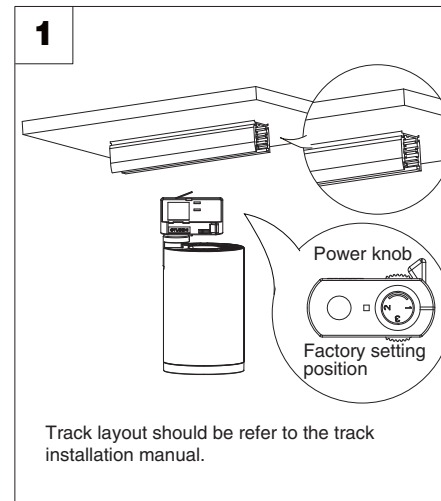

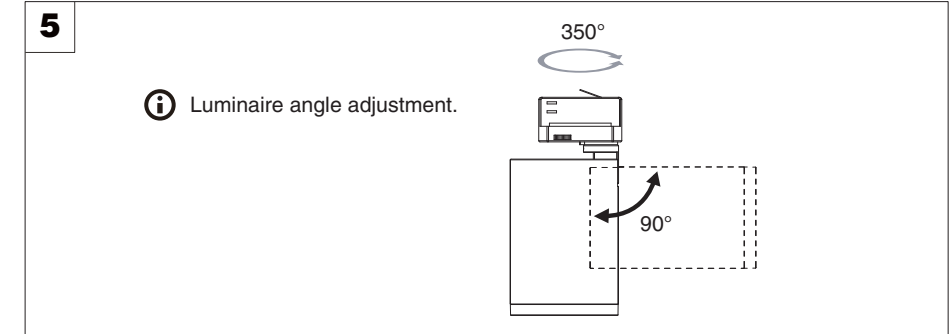
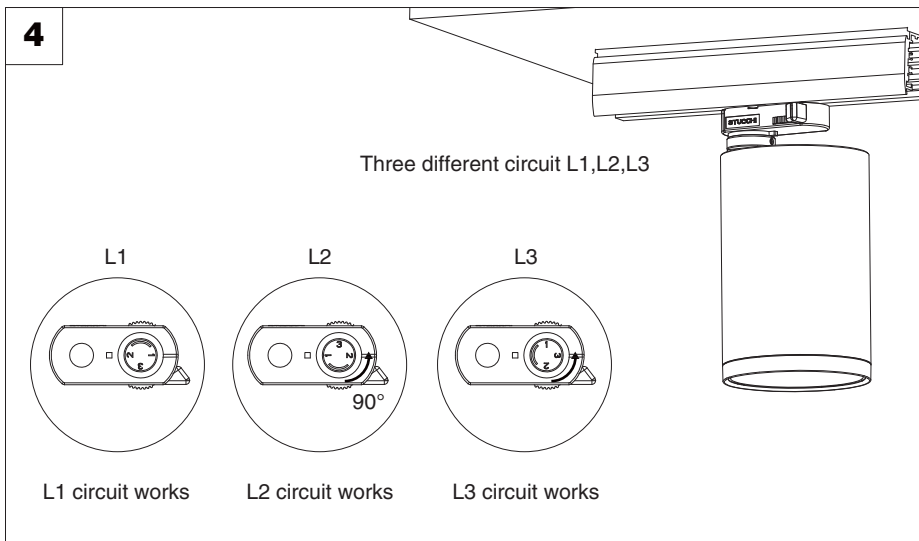
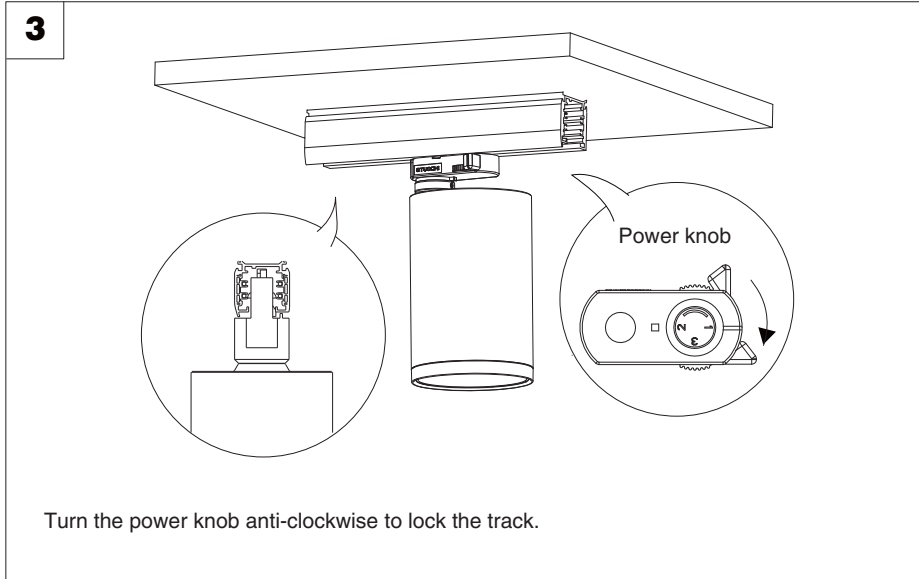

ⓘ Feature 1:

The reflector can be replaced for Track spot COB series.
Replace reflector according to your desired beam angle.

1. Open the cover with a suction lifter.

TELEP2-R1-120V-2
TELEP2-R1-220V-2

2. The reflector rotates out counterclockwise to replace a new one. Then install the cover.

NOTE: The operation should be done only by a qualified electrician.

SELF Electronics Co.,Ltd.

No. 1345 JuXian Road, Ningbo Hi Tech Park, Ningbo, China 315103