

SLPU-2P1U1C1S-BK



ELECTRICAL

With 1 × USB-A charger port (Rated 5Vdc, 3.1A)
 With 1 × USB-C charger port
 (Rated 5VDC 3.1A, 9VDC 2A, 12VDC 1.5A)
 USB charger built-in open circuit, short circuit, over load protection
 2 × TR AC Receptacles, rated 15A, 125Vac
 1x Switch, controls the rear receptacle for LED light fixtures
 10' 14 AWG x 3C power cord with 5-15P plug
 8" rear/side exiting cord with receptacle



MECHANICAL

Recessed mounting



CERTIFICATION

FCC compliant and UL Listed



WARRANTY

5 Years



Dimension(inches/mm)

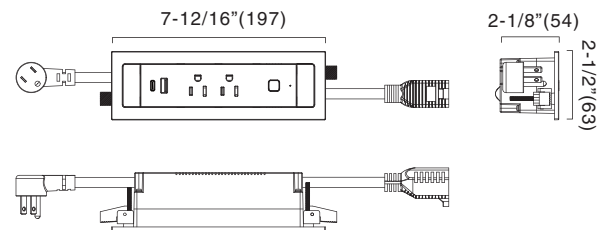

Installation

Cut hole size:
 7.40"×2.09"(188mm×53mm)

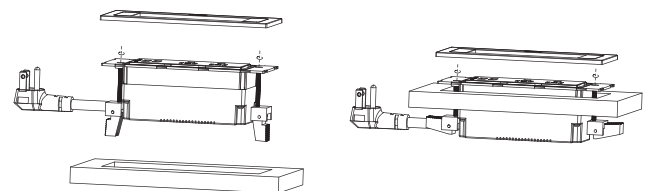

*Thickness of the board:8~35mm

SLPU-2P1U1C1S-WH



ELECTRICAL

With 1 × USB-A charger port (Rated 5Vdc, 3.1A)
 With 1 × USB-C charger port
 (Rated 5VDC 3.1A, 9VDC 2A, 12VDC 1.5A)
 USB charger built-in open circuit, short circuit, over load protection
 2 × TR AC Receptacles, rated 15A, 125Vac
 1x Switch, controls the rear receptacle for LED light fixtures
 10' 14 AWG x 3C power cord with 5-15P plug
 8" rear/side exiting cord with receptacle



MECHANICAL

Recessed mounting



CERTIFICATION

FCC compliant and UL Listed



WARRANTY

5 Years



Dimension(inches/mm)

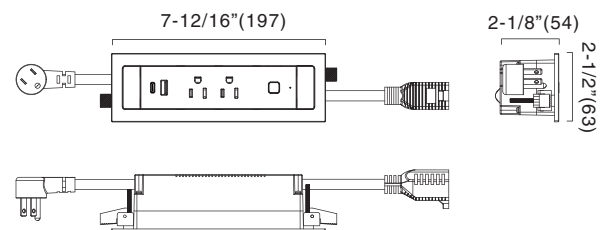

Installation

Cut hole size:
 7.40"×2.09"(188mm×53mm)

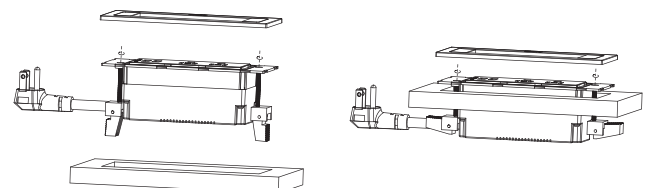

*Thickness of the board:8~35mm

SLPU-2P1U1C1S-NI



ELECTRICAL

With 1 × USB-A charger port (Rated 5Vdc, 3.1A)
 With 1 × USB-C charger port
 (Rated 5VDC 3.1A, 9VDC 2A, 12VDC 1.5A)
 USB charger built-in open circuit, short circuit, over load protection
 2 × TR AC Receptacles, rated 15A, 125Vac
 1x Switch, controls the rear receptacle for LED light fixtures
 10' 14 AWG x 3C power cord with 5-15P plug
 8" rear/side exiting cord with receptacle



MECHANICAL

Recessed mounting



CERTIFICATION

FCC compliant and UL Listed



WARRANTY

5 Years



Dimension(inches/mm)

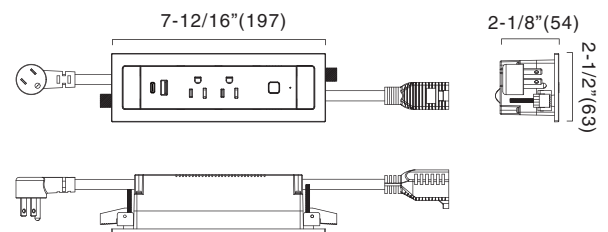

Installation

Cut hole size:
 7.40"×2.09"(188mm×53mm)

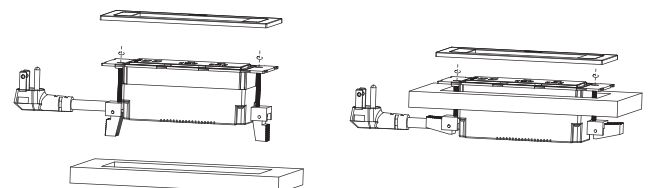

*Thickness of the board:8~35mm