

## CUL mark

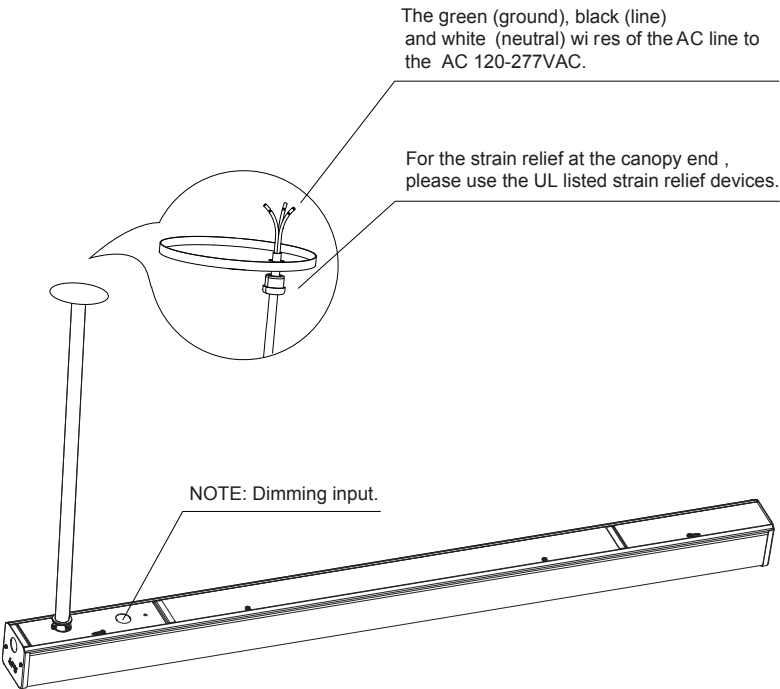

## PATH VISION

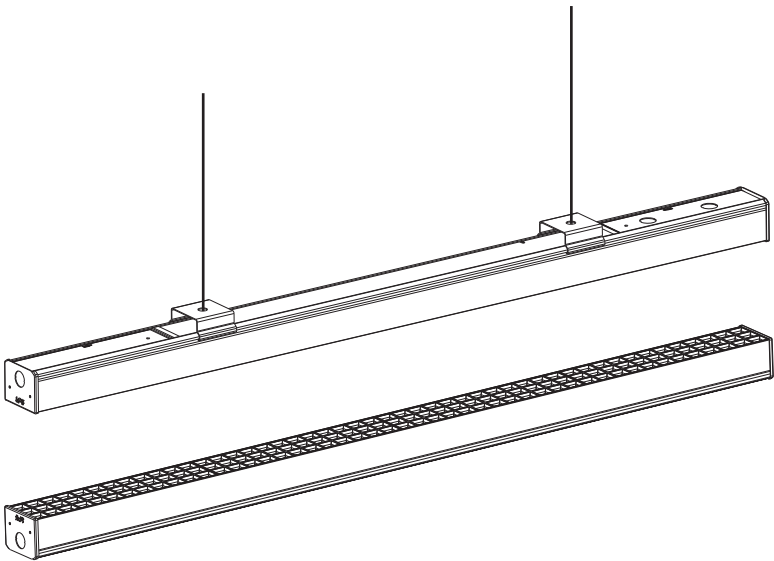

Instruction Manual  
Series: PATH VISION

ATTENTIONS

**WARNING/AVERTISSEMENT**

**RISK OF ELECTRIC SHOCK**

- Turn power off before inspection, installation or removal.
- Properly ground electrical enclosure.

**RISK OF FIRE**

- Follow all NEC and local codes.
- Use only UL or IEC approved wire for input/output connections.
- Minimum size 18 AWG.

**THIS PRODUCT MUST BE INSTALLED IN ACCORDANCE WITH THE APPLICABLE  
INSTALLATION CODE BY A PERSON FAMILIAR WITH THE CONSTRUCTION AND  
OPERATION OF THE PRODUCT AND THE HAZARDS INVOLVED**

Dimension: (Inches/mm)

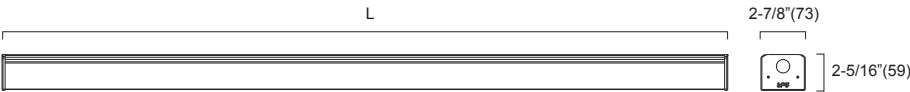

Model	Rated Input	length (L)	Power	Minimum Mounting Space (LXWXH)	Max. Linkage No. (28W/56W)	Max. Linkage No. (40W/80W)	ta
PATH VISION-L144-277V	120~277VAC	1197 (47-1/8")	28W/40W	1300X300X300 (51-3/16"X11-13/16"X11-13/16")	56@120VAC 106@277VAC	40 @120VAC 75 @277VAC	-20°C~35°C (-4~95°F)
PATH VISION-L288-277V	120~277VAC	2388 (94")	56W/80W	2500X300X300 (98-7/16"X11-13/16"X11-13/16")	28@120VAC 53@277VAC	20 @120VAC 37 @277VAC	-20°C~35°C (-4~95°F)

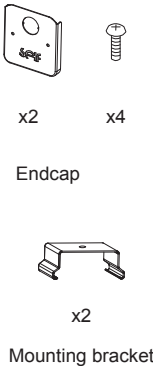

Optional

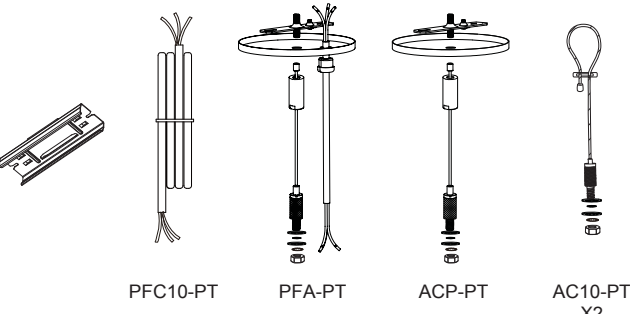

Tools

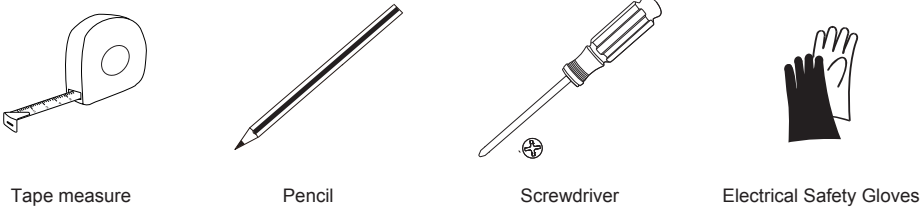

Installation Optionals

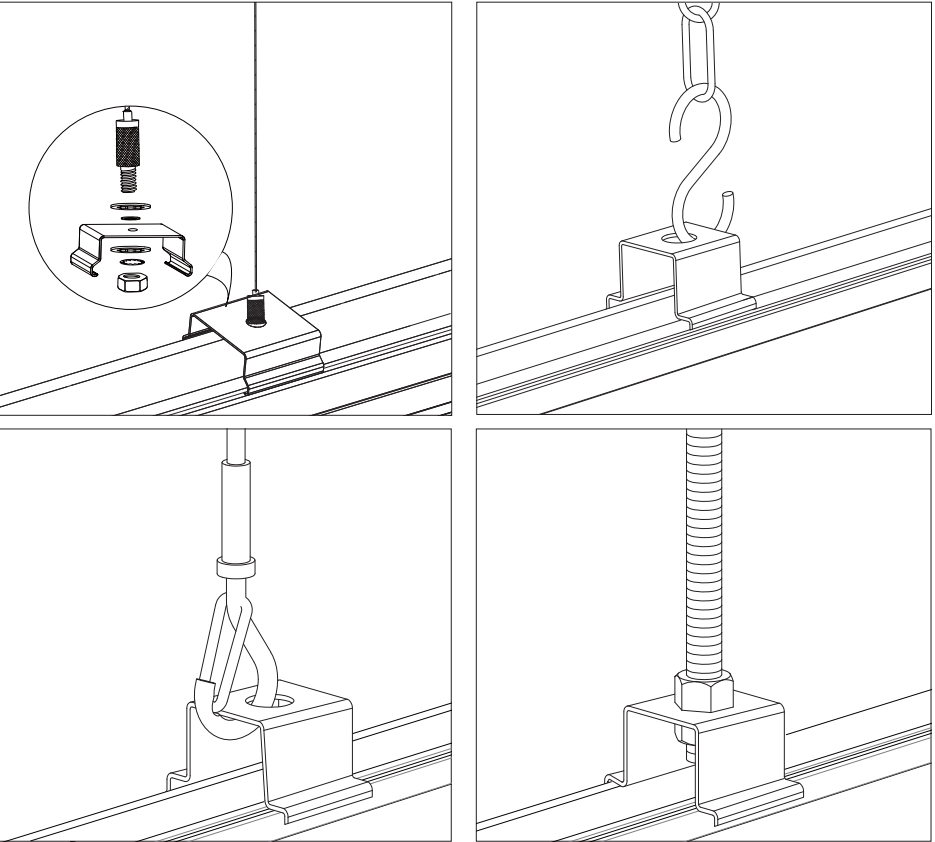

**Installation**

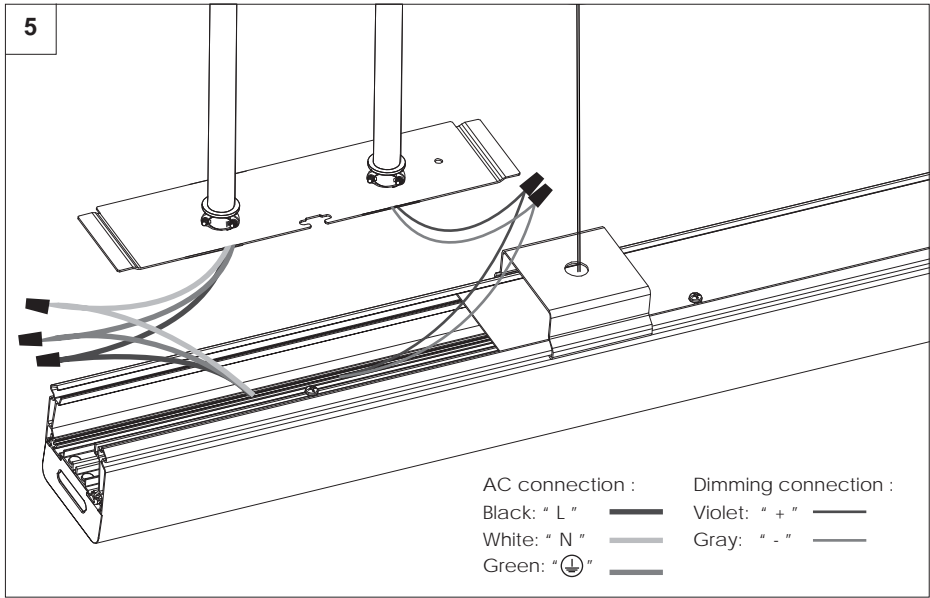
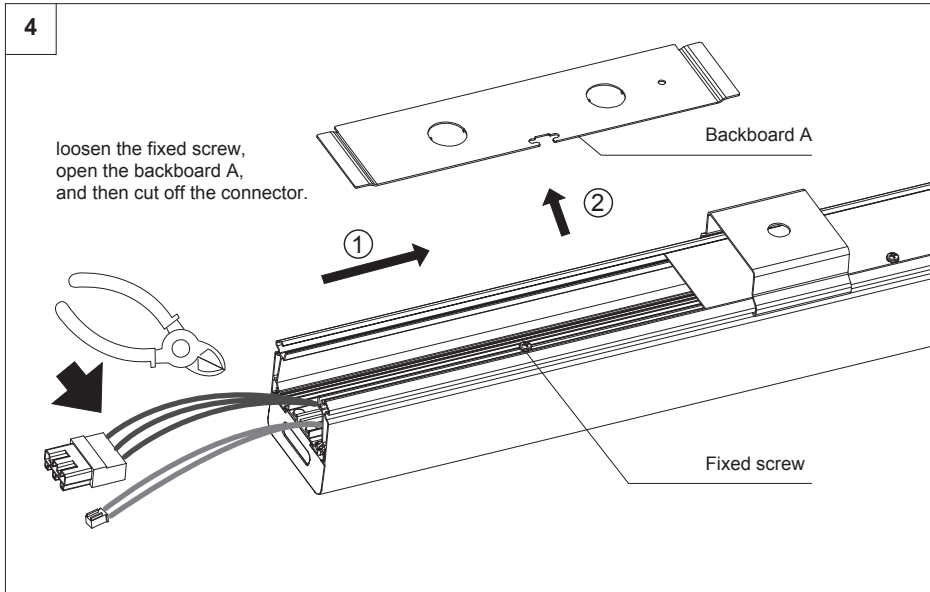
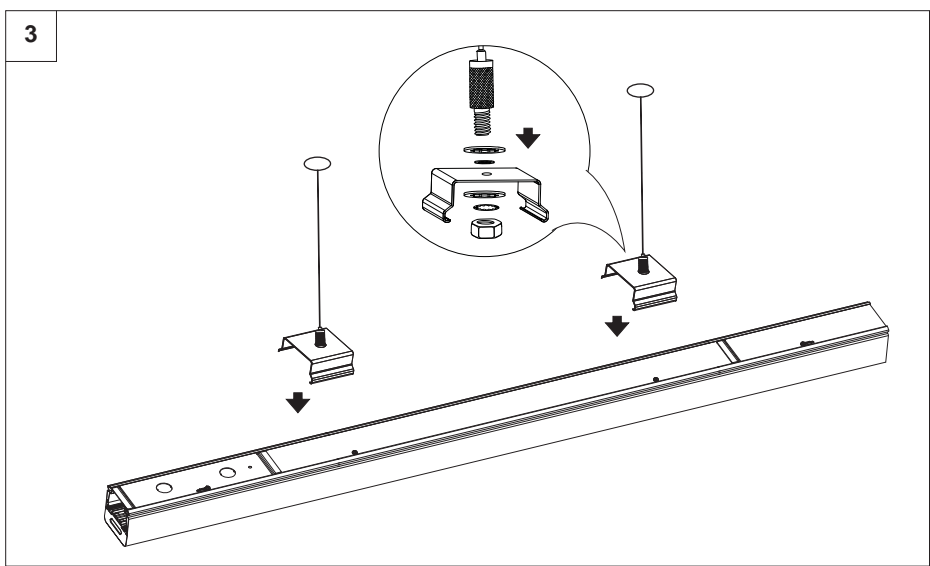
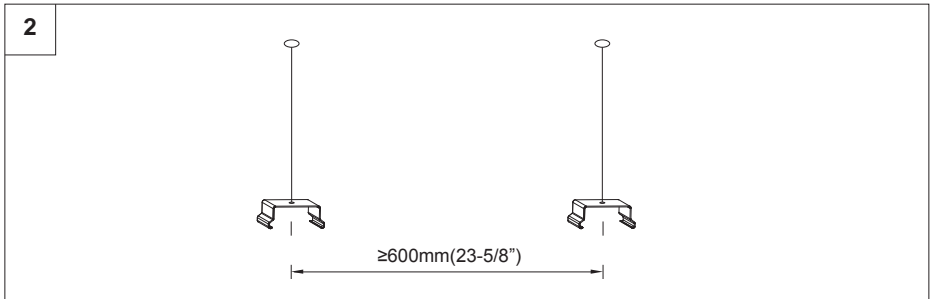
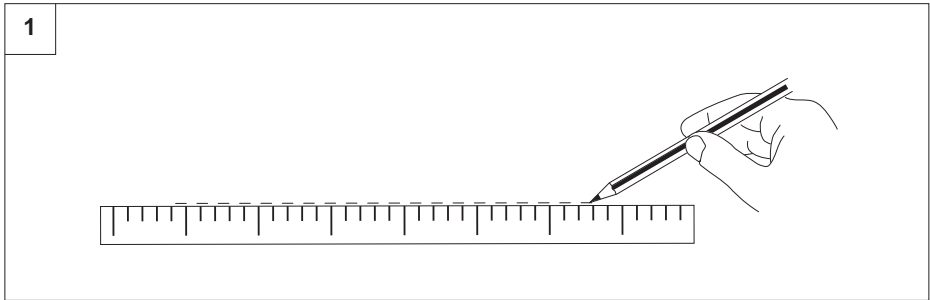

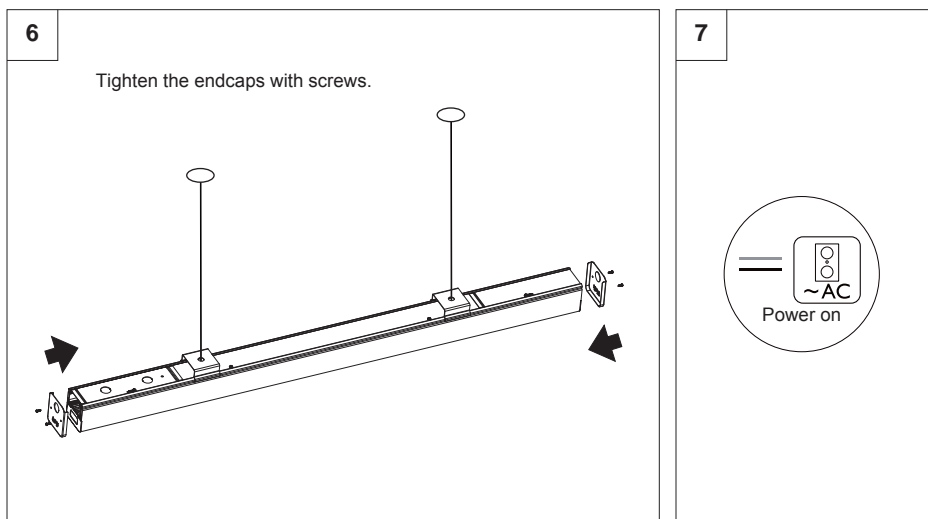

## **i** Dimmer

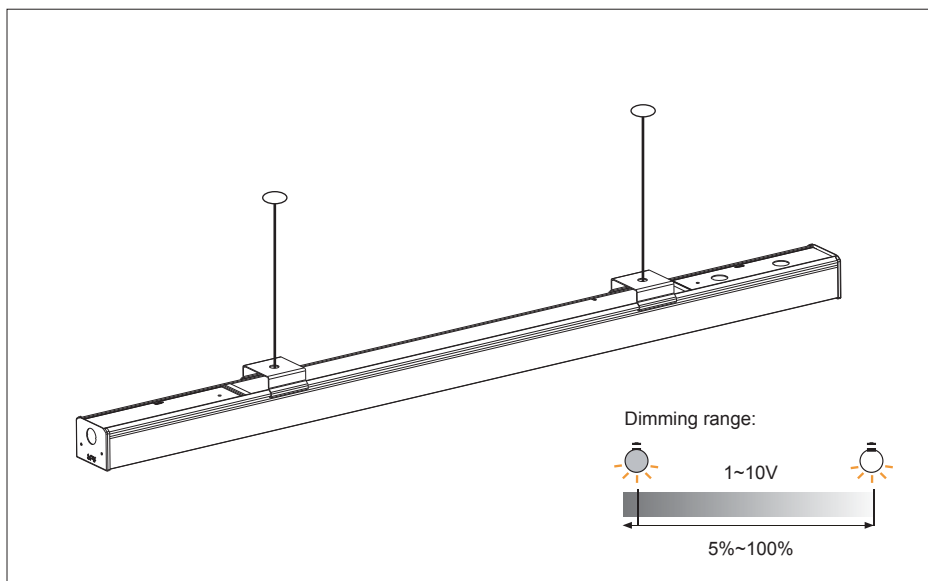

## **!** Continuous Run Installation

