

SATIN2

SATIN2 FROST

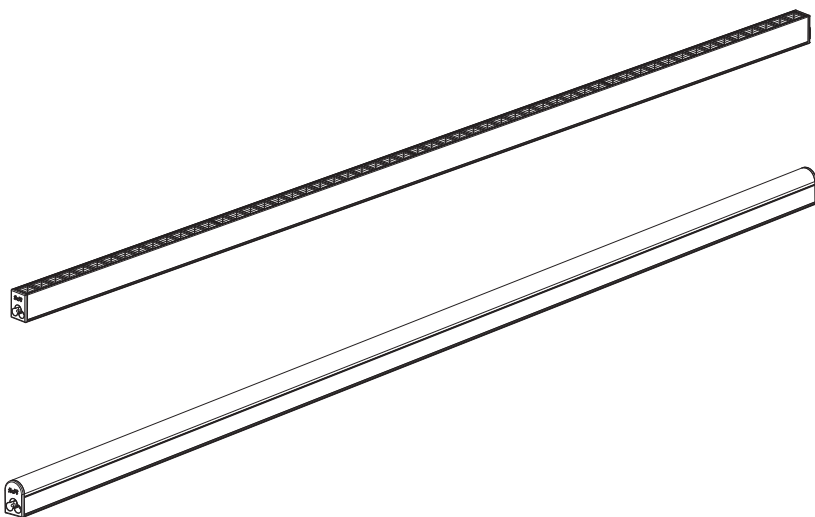

Instruction Manual

Series: SATIN2/SATIN2 FROST

Read these instructions completely and carefully.

ATTENTION/AVERTISSEMENT

RISK OF ELECTRIC SHOCK

- Turn power off before inspection, installation or removal.
- Properly ground electrical enclosure.

Regularly check the light source, the LED power supply, the cord and other accessories. Any constructive change of the luminaire shall not be permitted. If any part is damaged, the product should not be used. Please contact the manufacturer.

RISK OF FIRE

- Follow all NEC, national and local codes.
- Use only UL approved wire for input/output connections.
- Minimum size 18 AWG

Wasted PCB during transit, delivery, use and scrap disposal can cause certain environmental damage. Please handle it according to "waste electronic products disposal rules" locally.

THIS PRODUCT MUST BE INSTALLED IN ACCORDANCE WITH THE APPLICABLE INSTALLATION CODE BY A PERSON FAMILIAR WITH THE CONSTRUCTION AND OPERATION OF THE PRODUCT AND THE HAZARDS INVOLVED.

RISQUE DE DÉCHARGES ÉLECTRONIQUES

- Coupez l'alimentation avant d'inspection, installer ou déplacer le luminaire.
- Assurez-vous de correctement mettre à la terre le boîtier d'orientation électrique.

N'utilisez que des fils approuvés par UL ou IEC pour les entrées/sorties de connexion.
Taille minimum 18 AWG

Risque d'incendie

- Respectez tous les codes NEC et codes locaux
- N'utilisez que des fils approuvés par UL ou IEC pour les entrées/sorties de connexion.
- Taille minimum 18 AWG

CE PRODUIT DOIT ÊTRE INSTALLÉ CONFORMÉMENT AUX CODES D'INSTALLATIONS APPLICABLES PAR UNE PERSONNE FAMILIÈRE AVEC LA CONSTRUCTION ET L'OPÉRATION DU PRODUIT ET DES DANGERS CONCERNÉS.

UNE DÉVIATION PAR RAPPORT A L'INSTRUCTION D'ASSEMBLAGE PEUT ENTRAINER DES RISQUES D'INCENDIE, DE DÉCHARGE ÉLECTRONIQUE.

Dimension: (inches/mm)

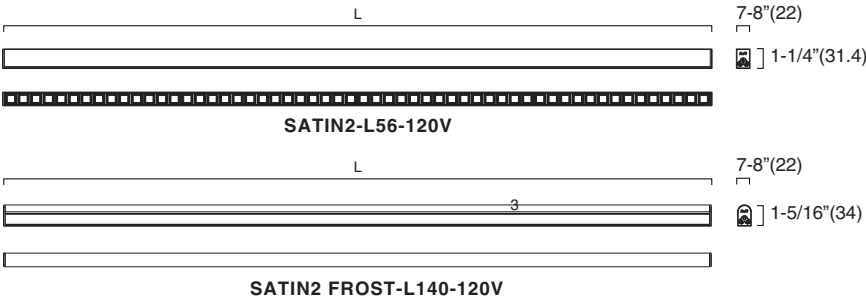

Specifications :

Model	Length (L)	Rated Input	Wattage (W)	Minimum Mounting Space (LXWXH)	Max.Linkabe No.	ta
SATIN2-L56-120V	44-7/8" (1140)	120VAC	20	51-3/16"X11-13/16"X11-13/16" (1300X300X300)	28 @ 120V	-4°F~-95°F (-20°C~-35°C)
SATIN2 FROST-L140-120V	44-7/8" (1140)		20	51-3/16"X11-13/16"X11-13/16" (1300X300X300)	28 @ 120V	-4°F~-95°F (-20°C~-35°C)



SATIN2
LAMP x1

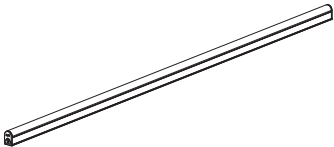

SATIN2 FROST
LAMP x1

Components:



Screw
x 2



180°
Mounting clip
x 2

Optional

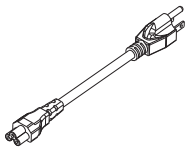

Input cable
x1

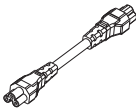

Soft link connector
x1



Hard link connector
x1



Wiring box
x1

Tools:

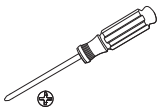

Screwdriver

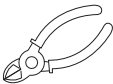

Pliers



Tape measure



Driller



Electrical safety gloves

❶ Shelves Installation

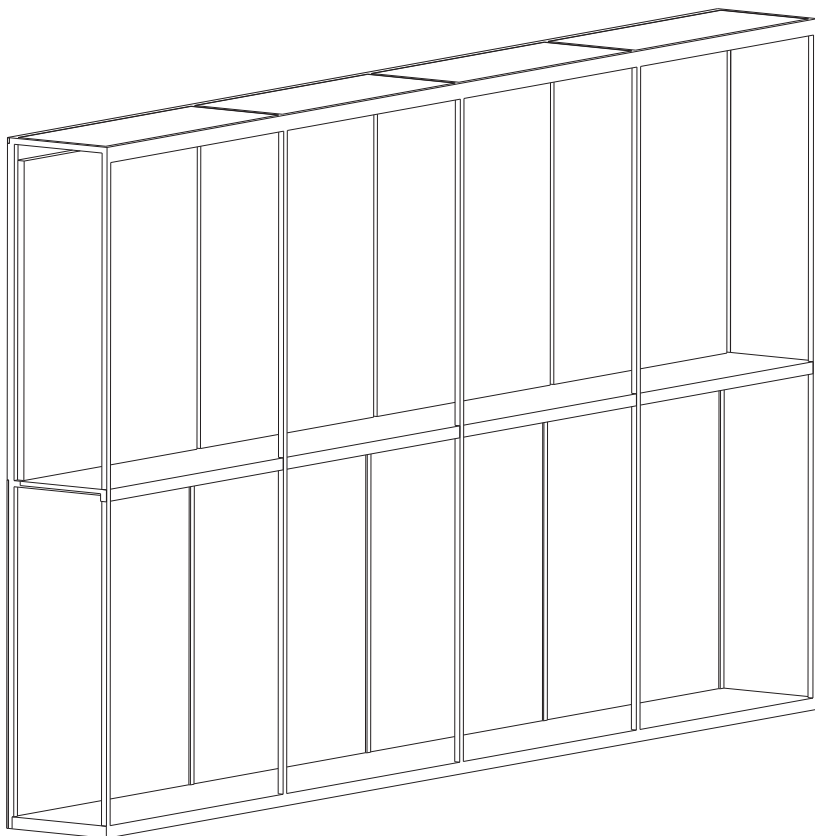

Install the clips .

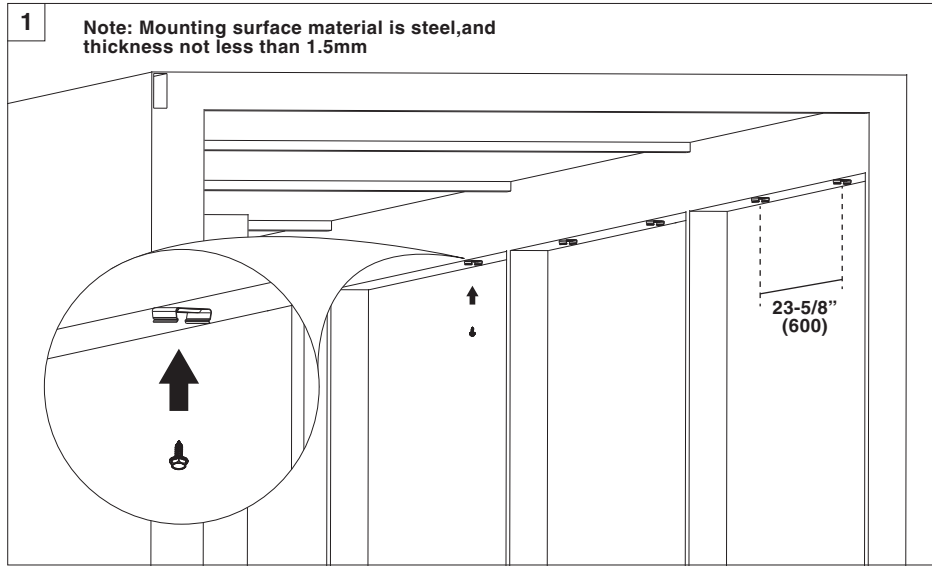

Install Lamps

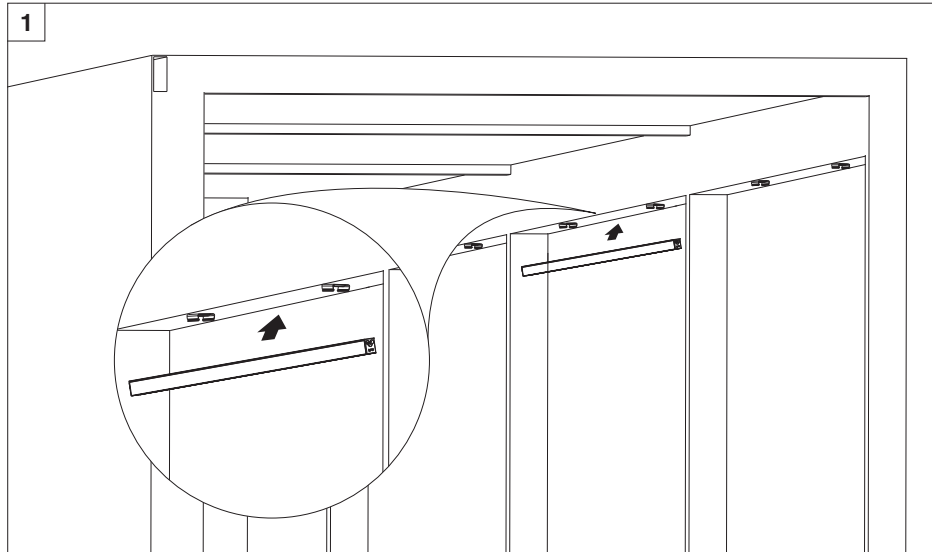

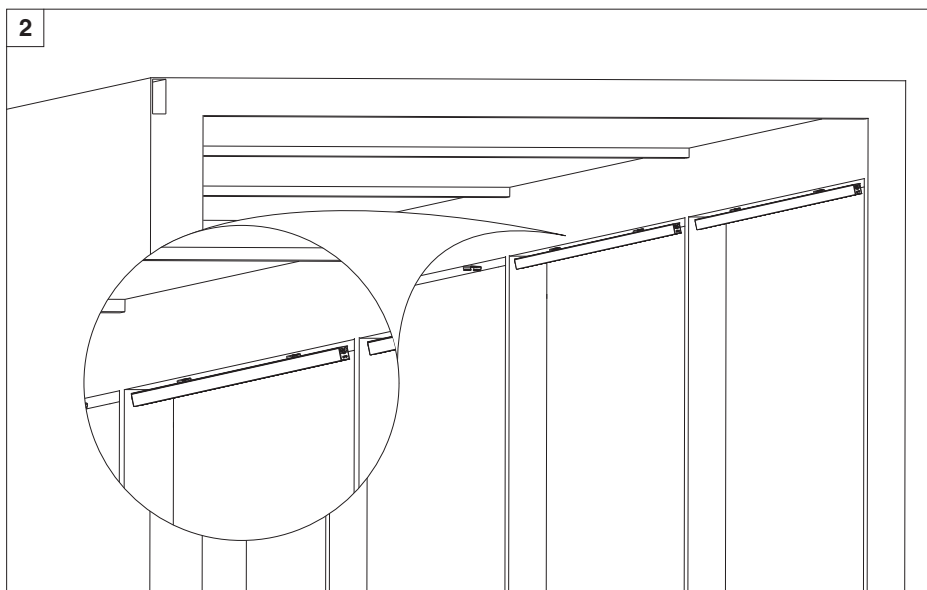

Interconnect

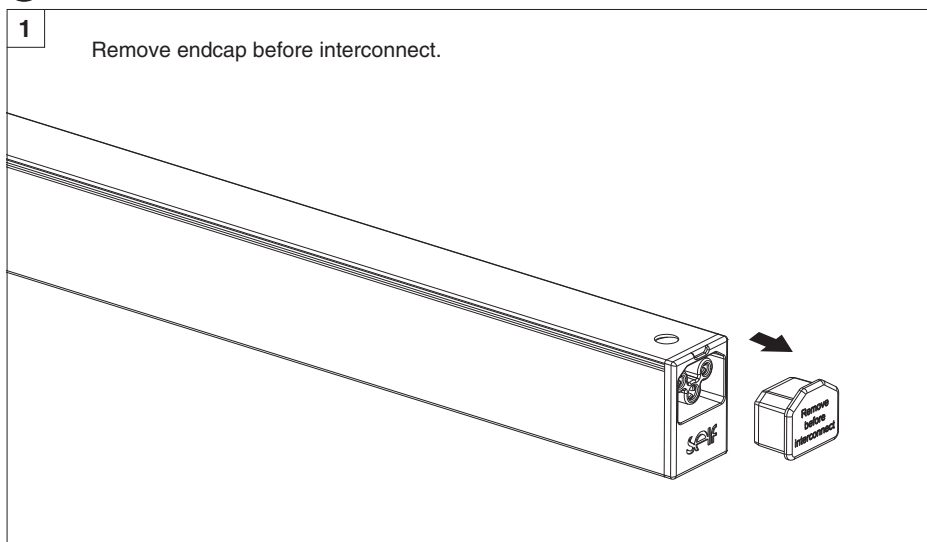

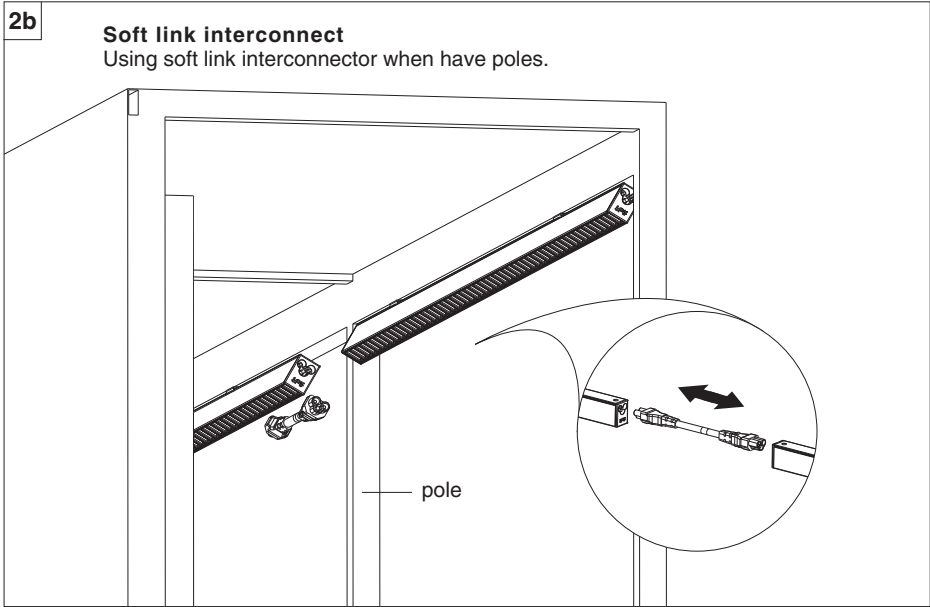
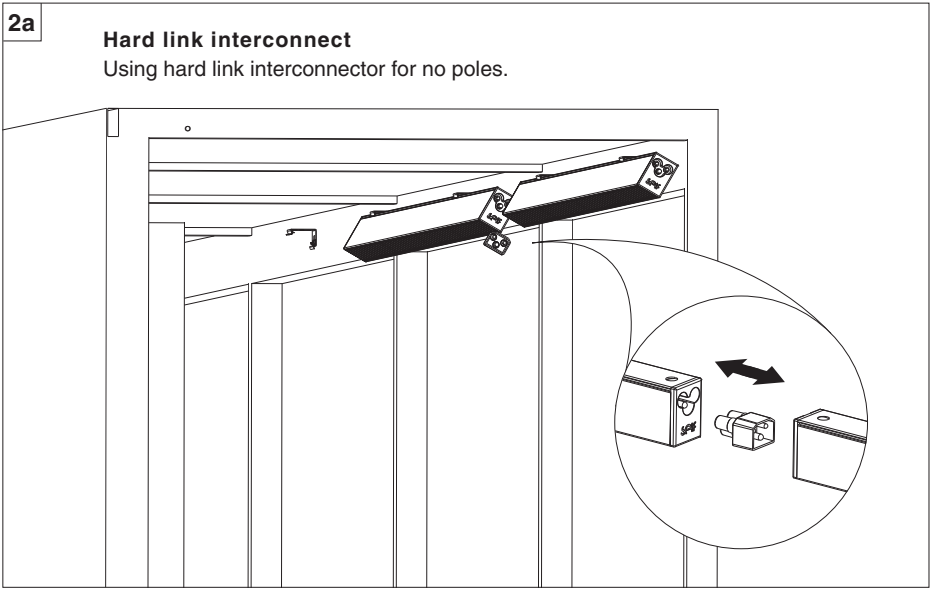

i Wiring diagram:

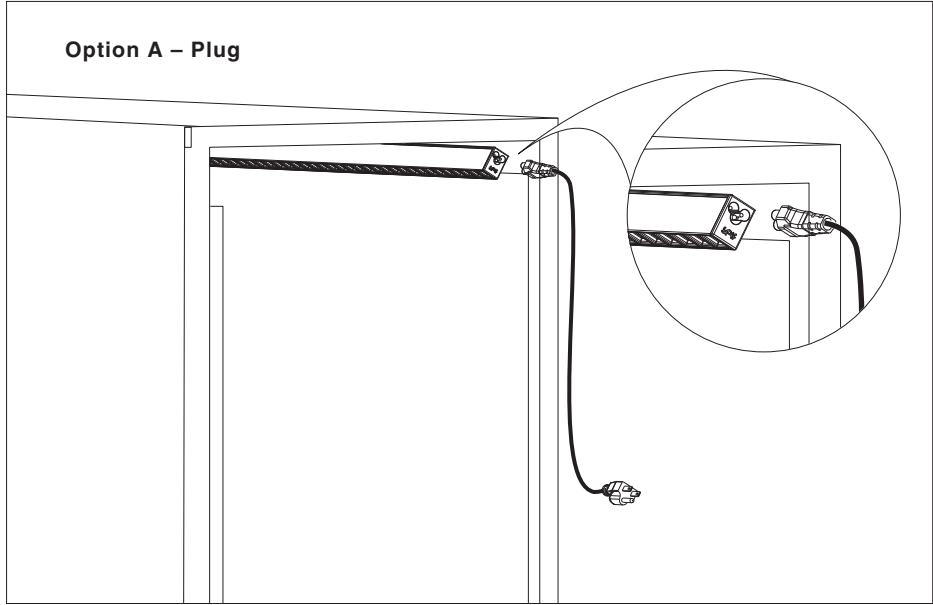

Option B – Hardwiring

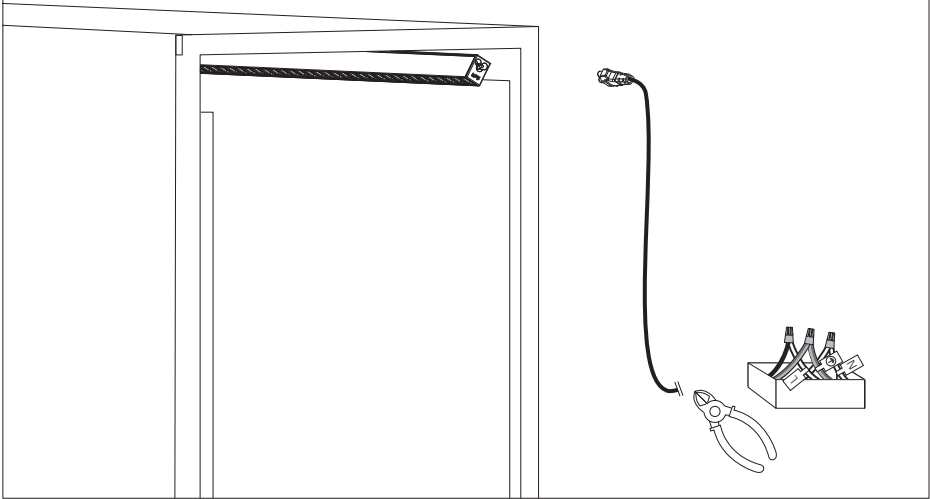

Convertible to Fixed Luminaires with UL Listed Metallic outlet box.

1. A suitable strain relief means should be added at the entrance of wiring box.
2. In the wiring box, branch wiring shall be permanently separated a minimum 6.4mm.
3. The length of the interconnection line should be controlled or fixed to the mounting surface using non-metal clips.

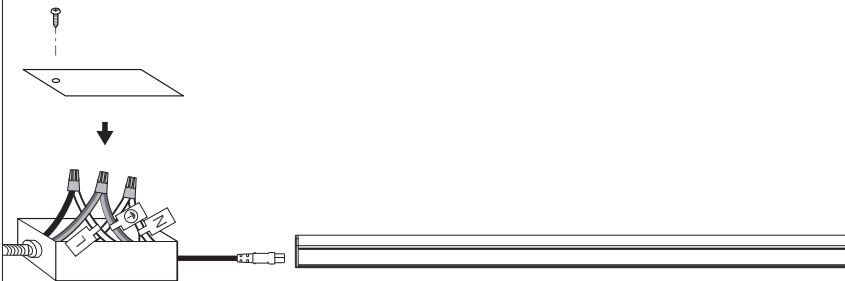

AC connection:

Black: " L "

White: " N "

Yellow/Green: " ⚡ "

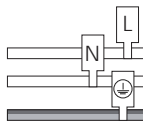

Power on.

