

# Instruction Manual

## Series: FORGE2

Read these instructions completely and carefully.

### ⚠ ATTENTIONS

Read the instruction carefully before installation. non-observance of this instruction may cause damage to the fixture or hurt to human body. The installation must be carried out by a qualified electrician in accordance with local or national codes. Cut off the power supply before installation and maintenance !

Regularly check the light source , the LED power supply, the cord and other accessories.  
If any part is damaged, the product should not be used.

Keep this instruction manual handy for future use.

The light source of these product are non-changeable light diodes(LED).  
Do not disassemble the product, as the light diode can cause damage to the eyes.  
Suitable for surface mounting only inside a cabinet.  
Install carefully to avoid hand or other parts of body clamped by magnet.  
Keep magnetizable objects away from the magnet and avoid touching the magnet.

**CAUTION:** To reduce the risk of fire, do not install in a compartment smaller than \_L\_ inches by 2" inches by 2" inches. (L see form ①)  
For damp locations

**AVERTISSEMENT:** Afin d'éviter tout risques d'incendie, ne pas installer dans un compartiment plus petit que L inch, par 1-15/16 inch, par 1-15/16 inch.

**Use only with Class 2 power supply**

### Dimension: (inches/mm)

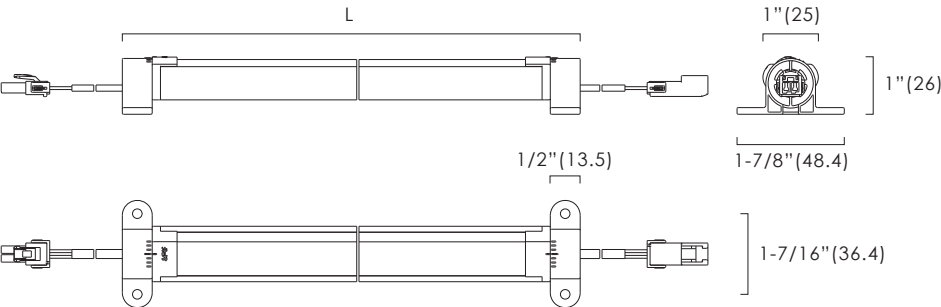

### Specifications:

| Model           | Length | Rated Input (VDC) | Wattage (W) | Minimum Mounting Space (LxWxH)                 | Max. Linkabe No. | ta                         |
|-----------------|--------|-------------------|-------------|--|------------------|----------------------------|
| FORGE2-L156-24V | 876    | 24                | 15          | 35-1/16"x11-13/16"x11-13/16"<br>(890x300x300)  | 5PCS             | -25°C~35°C<br>(-13°F~95°F) |
| FORGE2-L216-24V | 1181   | 24                | 20          | 47-1/16"x11-13/16"x11-13/16"<br>(1195x300x300) | 4PCS             | -25°C~35°C<br>(-13°F~95°F) |

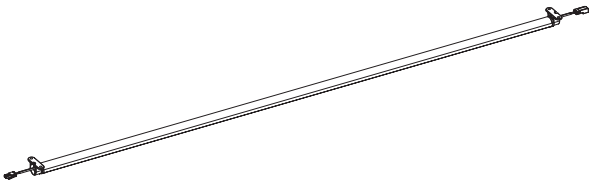

LAMP x1

### Components:



### Tools:

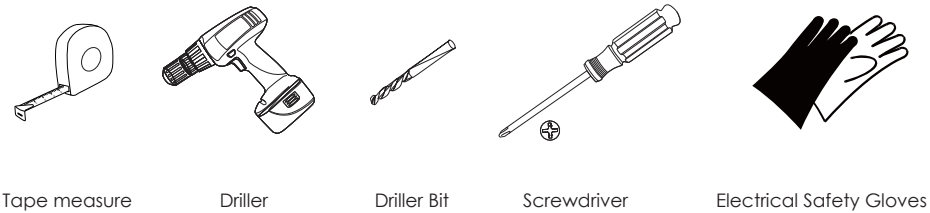

### ① Installation:

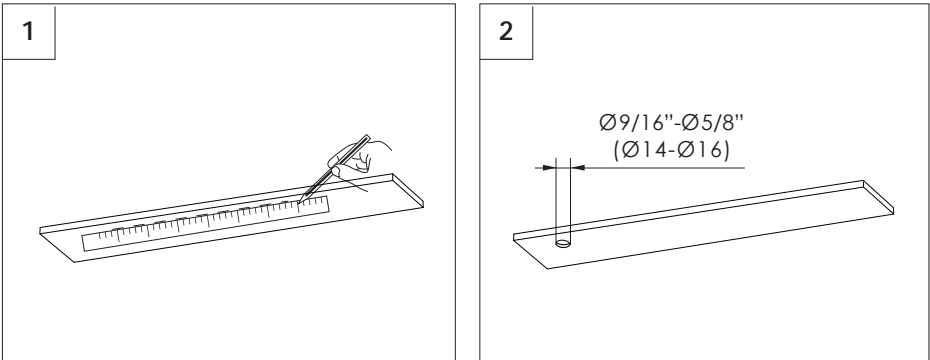

3

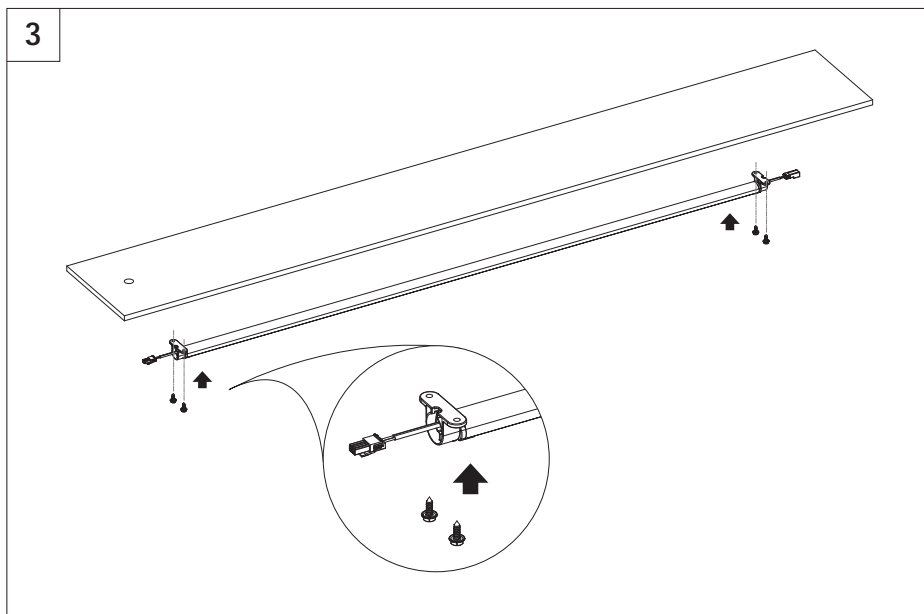

4

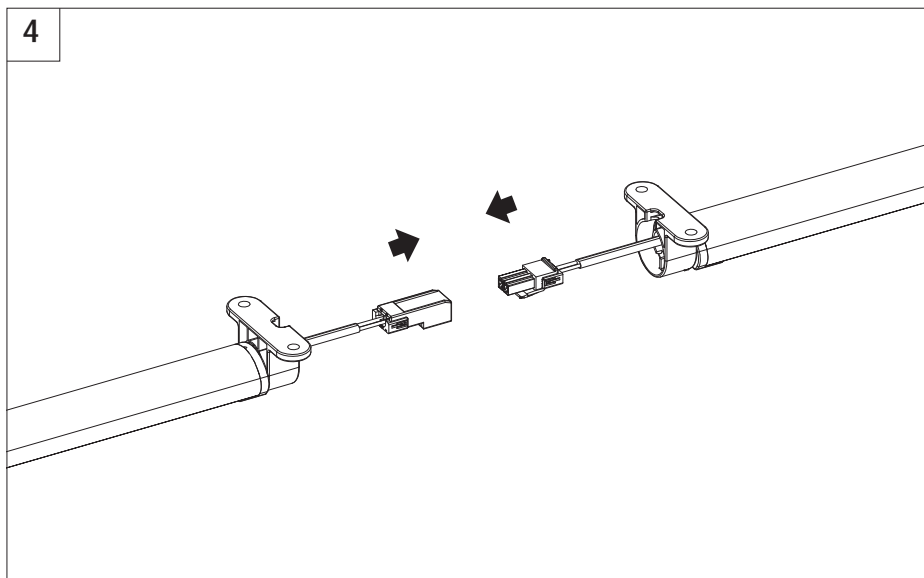

### **i** Wiring diagram:

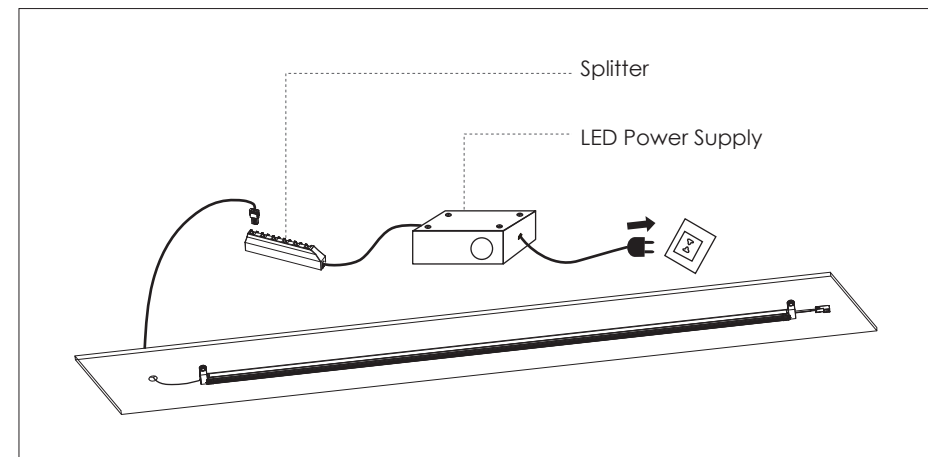

### **i** Recommended Installation Location:

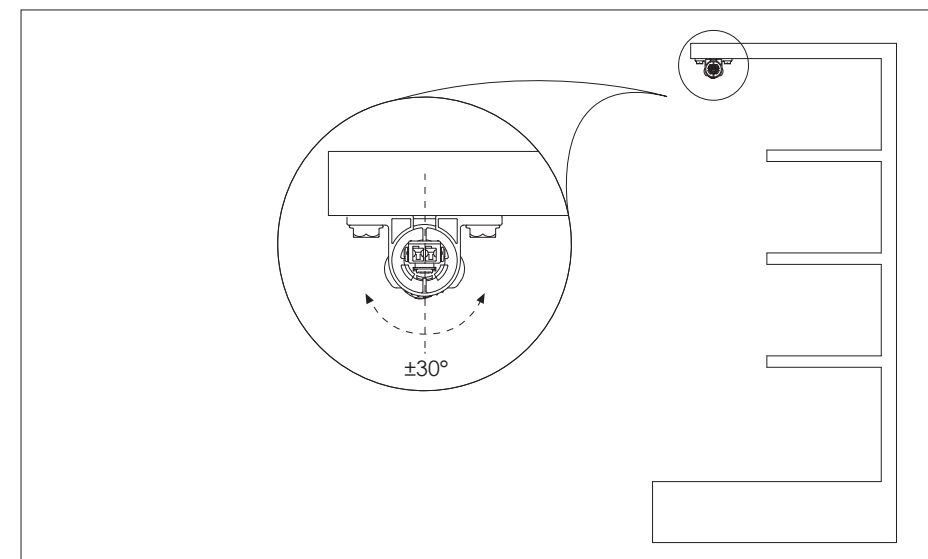

SELF Electronics Co.,Ltd.  
No. 1345 JuXian Road, Ningbo Hi Tech Park, Ningbo, China 315103