

Refrigerated Undershelf Lighting

FROZEN2



- Smooth continuous lighting
- Waterproof IP65

Refrigerated Undershef Lighting

FROZEN2



- Smooth continuous lighting
- Ra > 90, R9 > 50
- Easy installation with pre-assembled magnets
- IP rating: IP65 (for wet locations)
- Lifetime: 50,000hrs (ta=95°F, 35°C)
- Ta: -13°F~95°F (-25°C~35°C)
- 2.5W/ft, 300lm/ft
- Material: Aluminum alloy
- Other color temp available



Dimensions: inches, (mm)



How to order using our catalog numbers
Example: FROZEN2-1130K

Series	Length	CCT (K)	Beam Angle	Finish	Installation
FROZEN2	11 - 10.9"(276mm)	30K - 3000K 40K - 4000K	[blank] - 140°	[blank] - Natural Aluminum	[blank] - Pre-assembled magnets
	22 - 21.7"(551mm)				
	34 - 33.5"(851mm)				
	46 - 45.6"(1157mm)				

Specifications

Catalog No.	Model	Rated Input (VDC)	Ra	Power (W)	Luminous flux (TYP@4000K)lm	96W (17-9624DL-26)
FROZEN2-1130K FROZEN2-1140K	FROZEN2-L275-24V	24	92	2.5	300	33 pcs
FROZEN2-2230K FROZEN2-2240K	FROZEN2-L550-24V	24	92	5	600	17 pcs
FROZEN2-3430K FROZEN2-3440K	FROZEN2-L850-24V	24	92	7.5	900	11 pcs
FROZEN2-4630K FROZEN2-4640K	FROZEN2-L1175-24V	24	92	10	1200	9 pcs



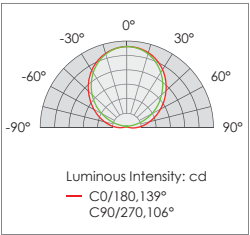

* Included: 1 pc LED fixture.

Photometrics

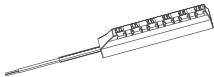
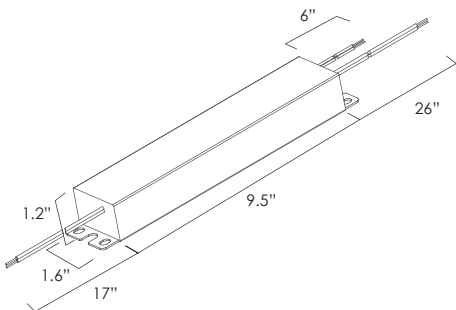

Refrigerated Undershelf Lighting

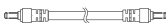
FROZEN2

Accessories	Catalog No.	Description	Length (inch)
	IC-FOZ2-108	 Input cable (Must be between the light and splitter) x 1	108"
	JB-6-8T	 6-way splitter, JB-6-4 input cable 8", end tinned	8"
	17-9624DL-26	 Model: SLD96-24VC-UN1 Matching 1-10V dimmable driver, max. 96W. Input: 120-277VAC 17" hard wire. Output: 24VDC 26" hard wire.	
Accessories (optional)	Catalog No.	Description	Length (inch)
	MC-FOZ2	 Mounting clip x2	-
	SC-FOZ2-12	 Soft connector	12"
	HC-FOZ2	 Hard connector	-
Note: When interconnected ,must use SC-FOZ2-12 or HC-FOZ2			

Refrigerated Undershelf Lighting

FROZEN2

Installation

Wood panel installation

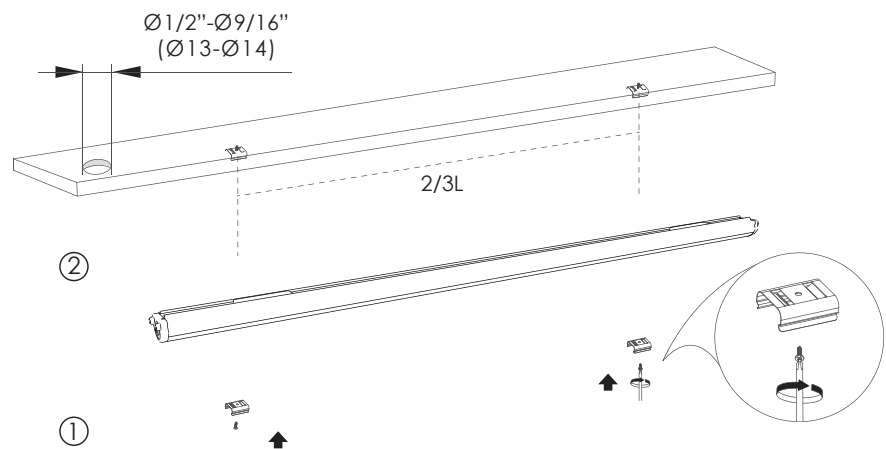

Iron panel installation

