

SMART MINI TRACK

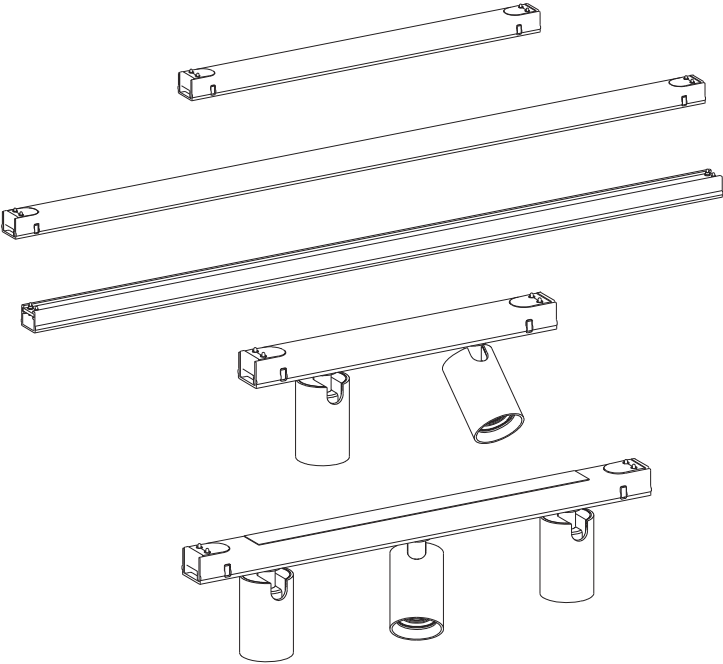

INSTRUCTION MANUAL

SERIES: SMART MINI TRACK

Read these instructions completely and carefully.



ATTENTIONS

- Read the instruction carefully before installation, non-observance of this instruction may cause damage to the product or hurt to human body. The installation must be carried out by a qualified electrician in accordance with local or national codes.
- Cut off the power supply before installation and maintenance !
- Cut off the power supply before the electric wire connection for product first test.
- Regularly check the light source , the LED power supply, the cord and other accessories. If any part is damaged, the product should not be used.
- The product is only for indoor and dry location. Clean the product with a damp cloth (no dripping water), preferably anti-static.
- Do not stare into LED beam.
- The light source contained in this luminaire shall only be replaced by the manufacturer or his service agent or a similar qualified person
- Installation instructions shall be included with the luminaires
- Instructions shall caution the user against installing the luminaire with other than the intended Class 2 power unit
- Installation instructions shall be provided that include specific instructions for maximum ambient
- FOR MINITRACK SPOTS-LX-24V, MINITRACK LINEAR-LX-24V, MINITRACK EYES-LX-24V: MAXIMUM 48 W.
- MINITRACK EYES-LX-24V can't work as a connector between the track.
- The lamp caps cannot illuminate each other, which will make the lamp temperature abnormal.

Lesen Sie diese Anweisungen vollständig und sorgfältig durch.



ACHTUNG

- Lesen Sie die Anweisungen sorgfältig vor der Installation durch. Bei Nichtbeachtung dieser Anweisung kann Schäden am Produkt oder Verletzungen am menschlichen Körper verursachen. Die Installation muss von einem qualifizierten Elektriker gemäß örtlichen oder nationalen Vorschriften durchgeführt werden.
- Schalten Sie die Stromversorgung vor der Installation und Wartung aus!
- Schalten Sie die Stromversorgung vor dem elektrischen Anschluss des Produkts für den ersten Test aus.
- Überprüfen Sie regelmäßig die Lichtquelle, das LED-Netzteil, das Kabel und andere Zubehörteile. Wenn ein Teil beschädigt ist, sollte das Produkt nicht verwendet werden.
- Bewahren Sie diese Bedienungsanleitung für zukünftige Verwendung auf.

Dimensions: (mm)

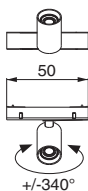

MINITRACK EYES-L1-24V

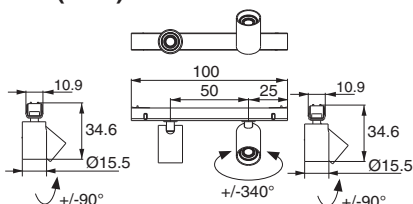

MINITRACK EYES-L2-24V

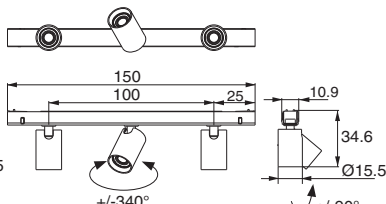

MINITRACK EYES-L3-24V

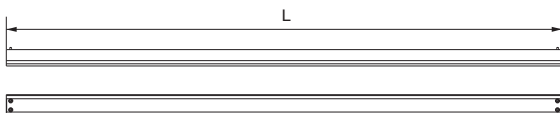

- MINITRACK LINEAR-L7-24V
- MINITRACK LINEAR-L28-24V
- MINITRACK LINEAR-L56-24V
- MINITRACK LINEAR-L112-24V
- MINITRACK LINEAR-L168-24V
- MINITRACK LINEAR-L196-24V
- MINITRACK LINEAR-L42-24V
- MINITRACK LINEAR-L126-24V
- MINITRACK LINEAR-L450-24V
- MINITRACK LINEAR-L550-24V
- MINITRACK LINEAR-L575-24V
- MINITRACK LINEAR-L850-24V

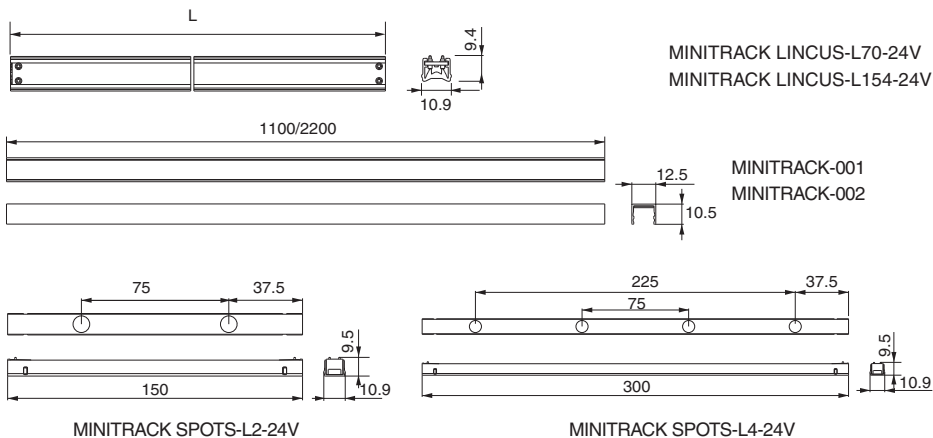

Specifications:

Model	Rated Input	Length	Power	ta	Minimum installation space	Max. Linkable(W)
MINITRACK EYES-L1-24V	24VDC	50mm	1.5W	-20°C~35°C	300 x 300 x 300mm	48
MINITRACK EYES-L2-24V	24VDC	100mm	2.5W	-20°C~35°C	350 x 350 x 350mm	48
MINITRACK EYES-L3-24V	24VDC	150mm	3.7W	-20°C~35°C	350 x 350 x 350mm	48
MINITRACK LINEAR-L7-24V	24VDC	30mm	0.7W	-20°C~35°C	200 x 300 x 300mm	48
MINITRACK LINEAR-L28-24V	24VDC	150mm	2.4W	-20°C~35°C	300 x 300 x 300mm	48
MINITRACK LINEAR-L56-24V	24VDC	300mm	4.8W	-20°C~35°C	300 x 300 x 400mm	48
MINITRACK LINEAR-L112-24V	24VDC	600mm	9.6W	-20°C~35°C	300 x 300 x 700mm	48
MINITRACK LINEAR-L168-24V	24VDC	900mm	14.4W	-20°C~35°C	300 x 300 x 1000mm	48
MINITRACK LINEAR-L196-24V	24VDC	1049mm	16.8W	-20°C~35°C	300 x 300 x 1200mm	48
MINITRACK LINEAR-L42-24V	24VDC	212mm	3.6W	-20°C~35°C	300 x 300 x 300mm	48
MINITRACK LINEAR-L126-24V	24VDC	712mm	10.8W	-20°C~35°C	300 x 300 x 800mm	48
MINITRACK LINEAR-L450-24V	24VDC	450mm	7.2W	-20°C~35°C	300 x 300 x 600mm	48
MINITRACK LINEAR-L550-24V	24VDC	550mm	8.4W	-20°C~35°C	300 x 300 x 700mm	48
MINITRACK LINEAR-L575-24V	24VDC	580mm	9W	-20°C~35°C	300 x 300 x 700mm	48
MINITRACK LINEAR-L850-24V	24VDC	850mm	13.2W	-20°C~35°C	300 x 300 x 1000mm	48
MINITRACK LINCUS-L70-24V	24VDC	372mm	6W	-20°C~35°C	300 x 300 x 400mm	48
MINITRACK LINCUS-L154-24V	24VDC	872mm	13.2W	-20°C~35°C	300 x 300 x 900mm	48
MINITRACK SPOTS-L2-24V	24VDC	150mm	2.5W	-20°C~35°C	300 x 300 x 300mm	48
MINITRACK SPOTS-L4-24V	24VDC	300mm	4.8W	-20°C~35°C	300 x 300 x 400mm	48

Based on: grand total of luminaires Power should not exceed 80% of rated power output of LED power supply.

Accessories:

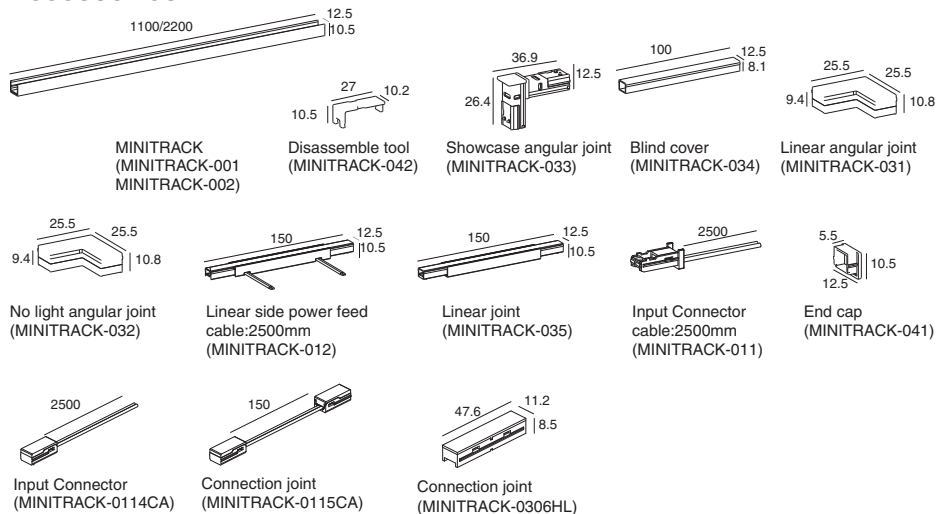

Optional

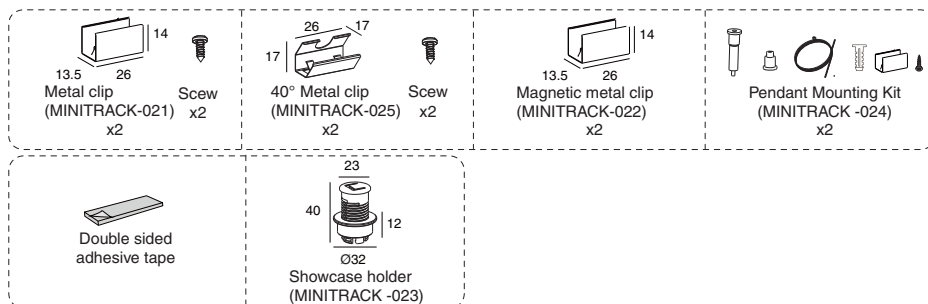

Tools:

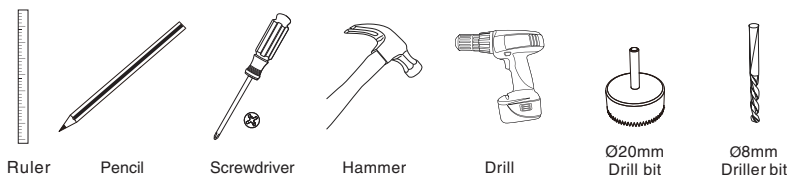

Recessed installation:

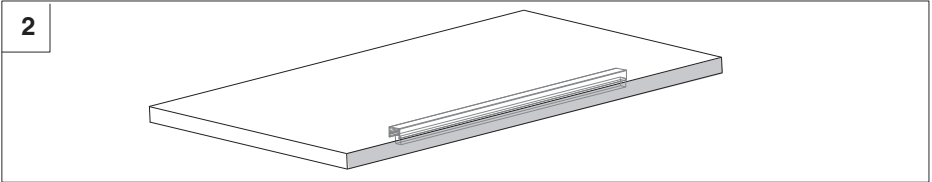
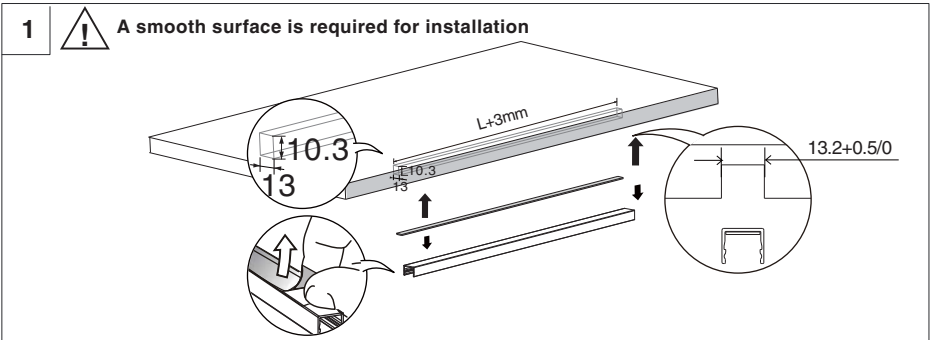

Surface mounting installation:

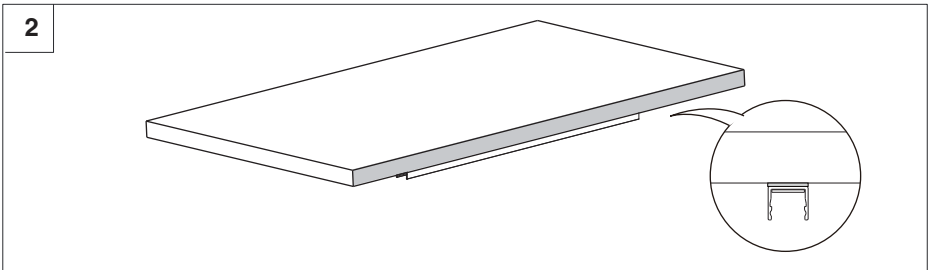
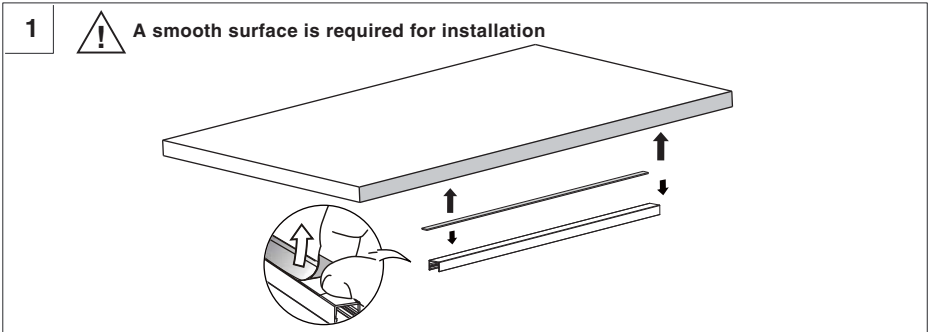

Metal clip installation:

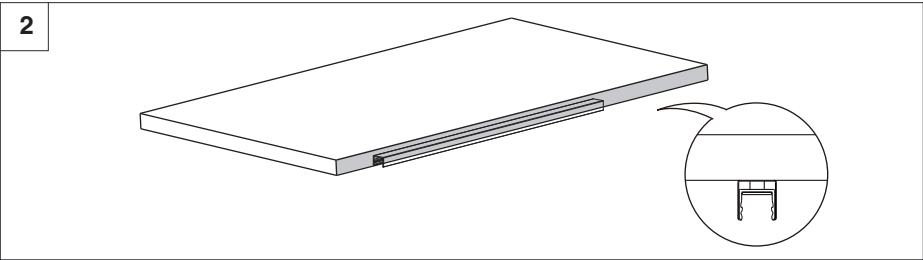
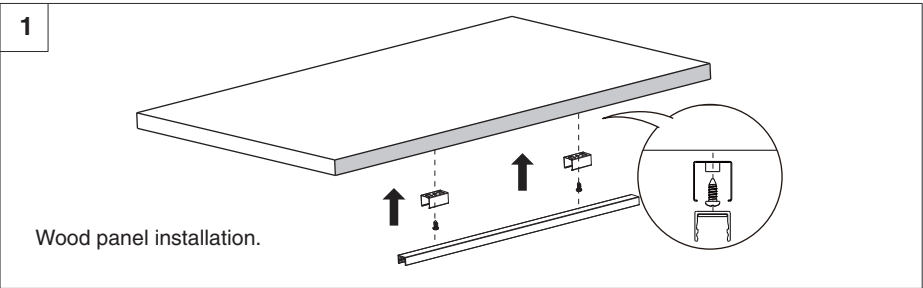

40° Metal clip installation:

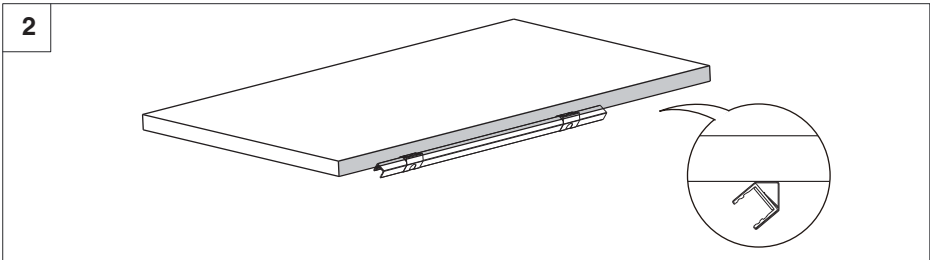
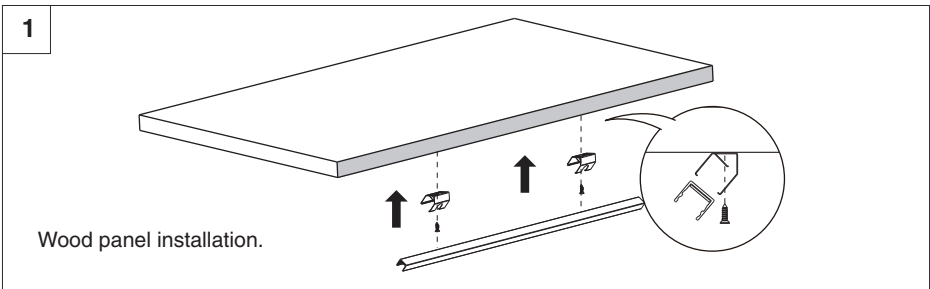

Magnetic metal clip installation:

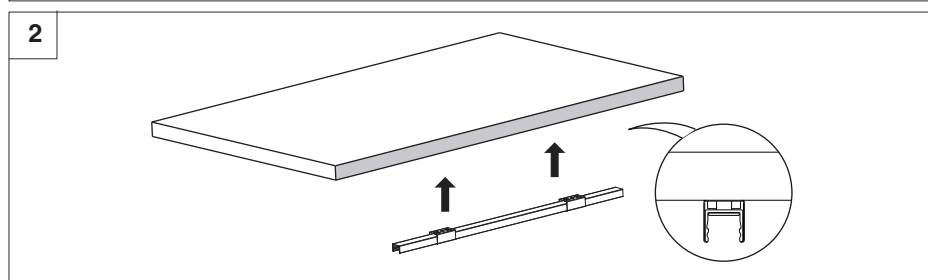
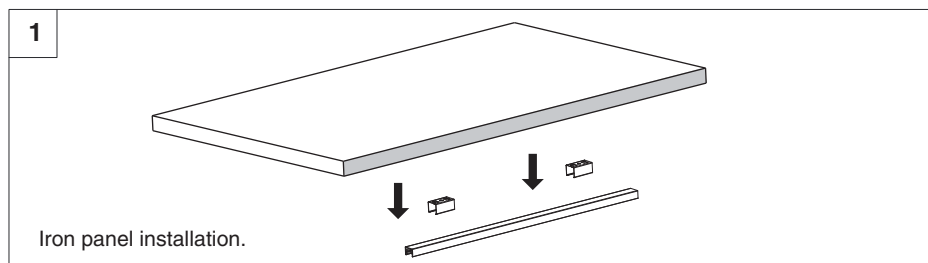

Pendant Mounting Installation:

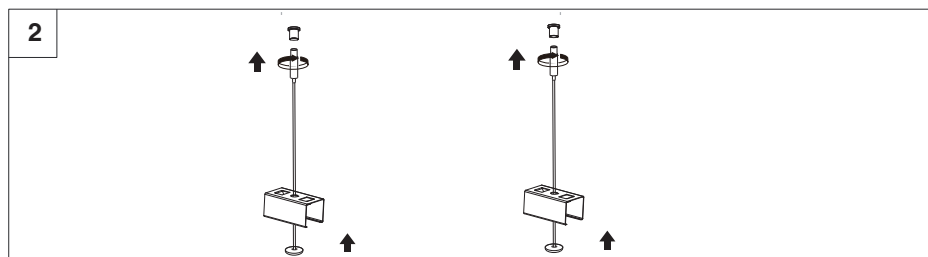
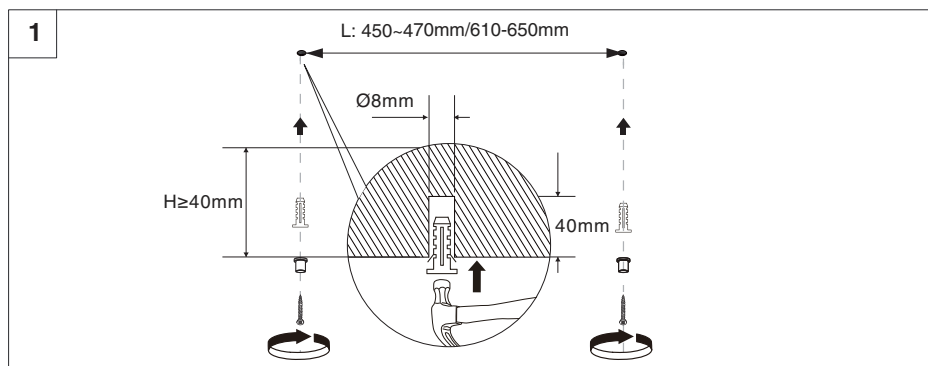

Pendant Mounting Installation:

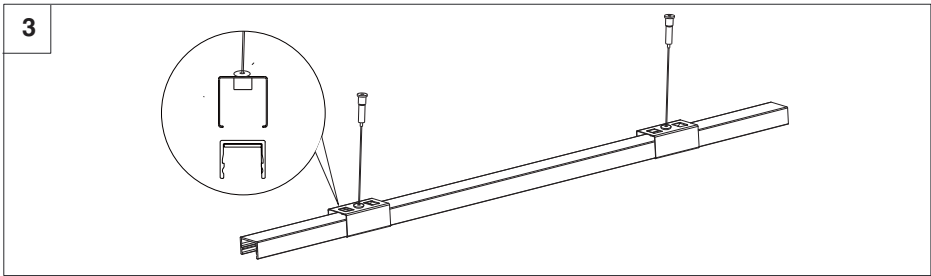

Showcase installation:

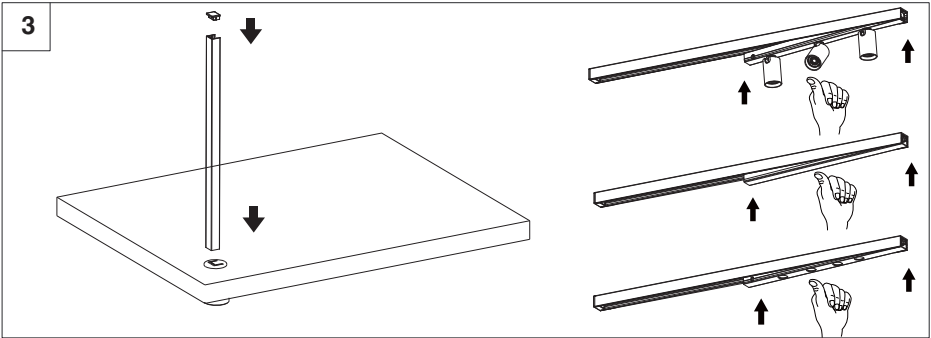
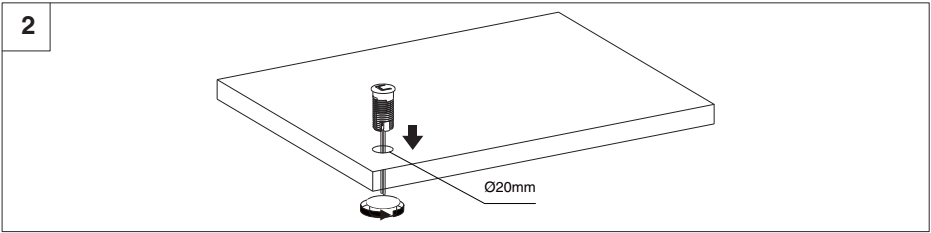
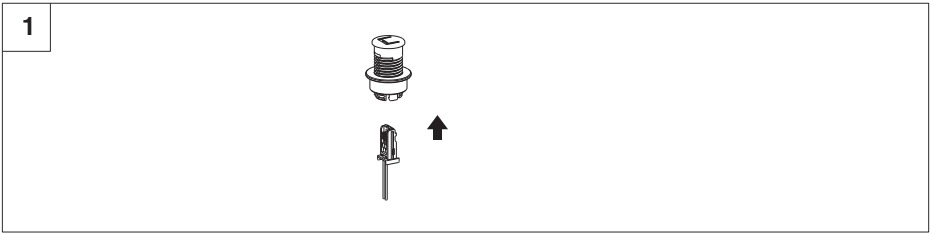

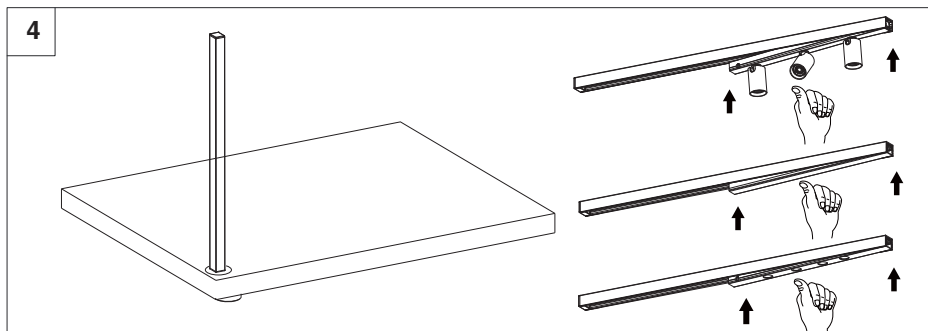

BEAM installation:

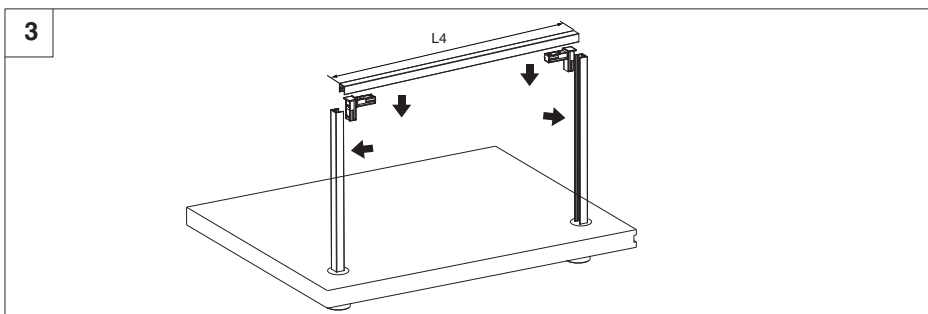
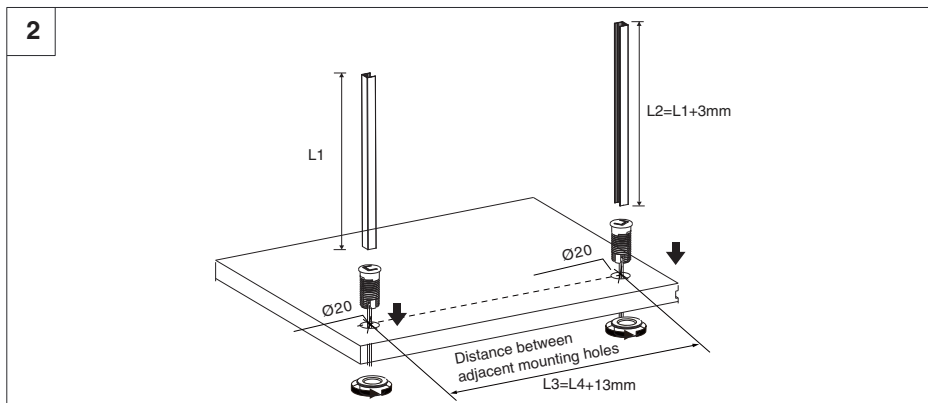
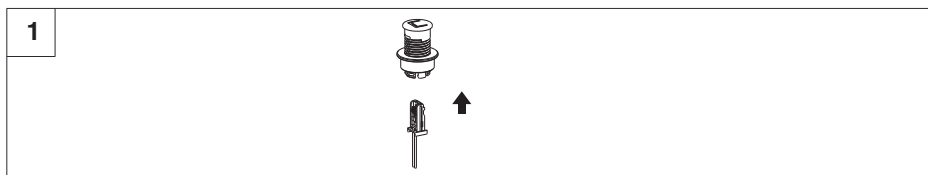

4

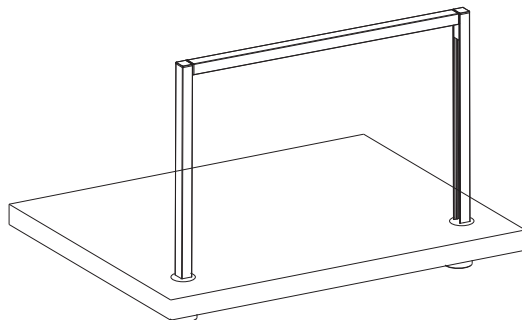

LED MODULE installation

MINITRACK EYES

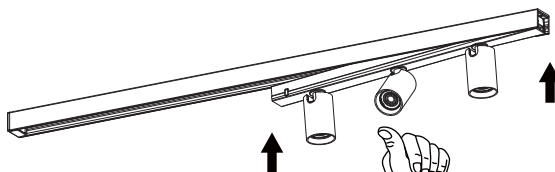

MINITRACK LINEAR

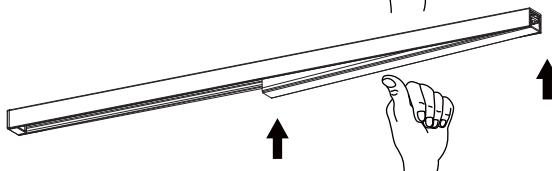

MINITRACK SPOTS

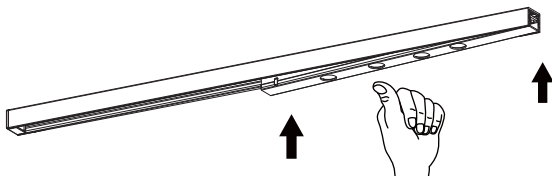

LED MODULE disassembling

MINITRACK EYES

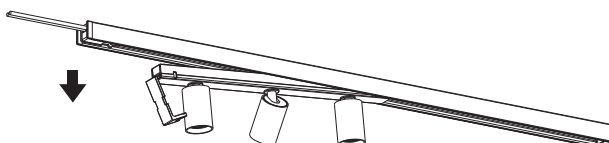

LED MODULE disassembling

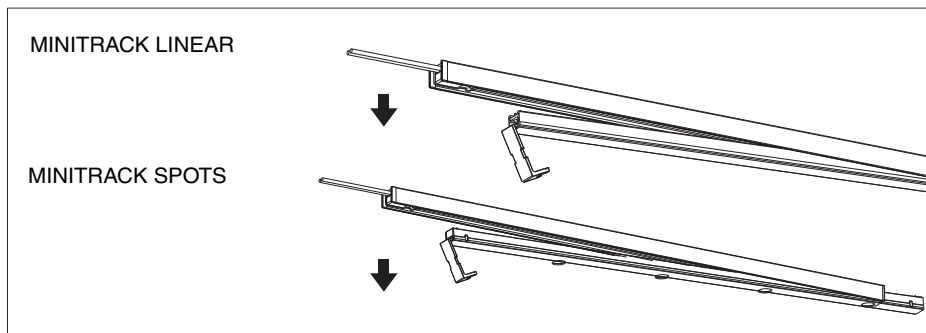

Joint installation:

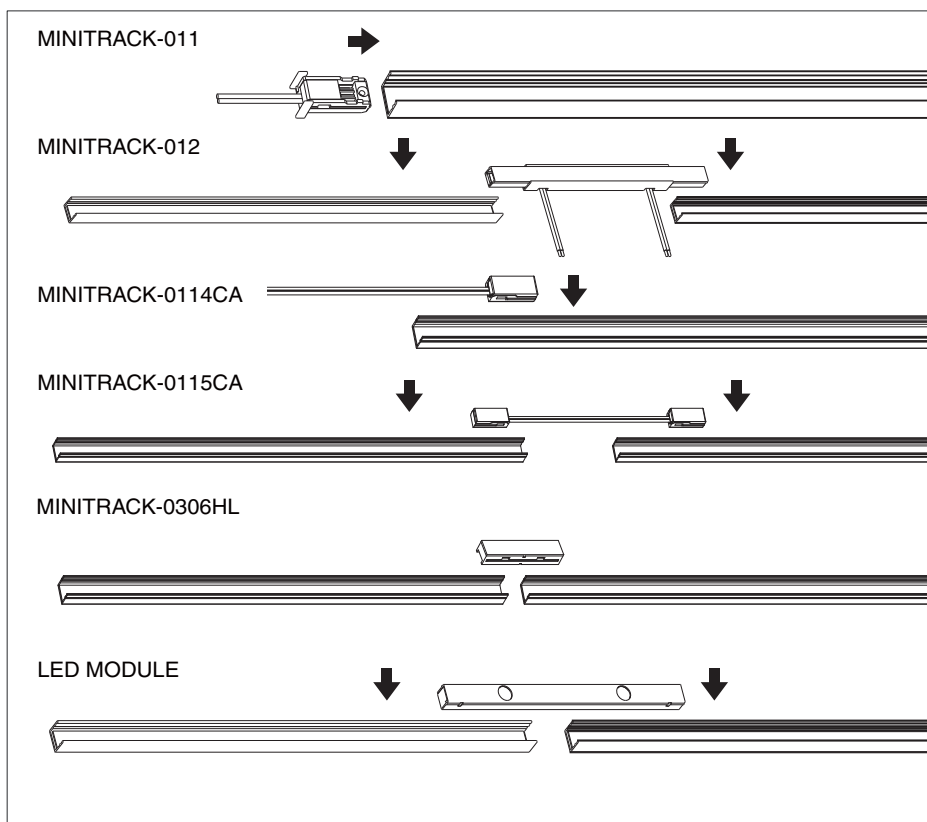

Joint installation:

⚠ MINITRACK EYES

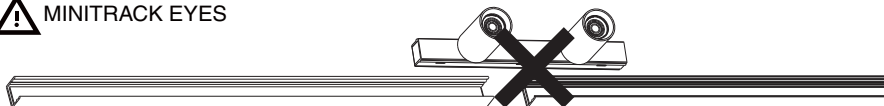

*ALL LED modules could work as a connector except MINITRACK EYES-LX-24V, and should conform to the max.linkable power.

MINITRACK-031
MINITRACK-032

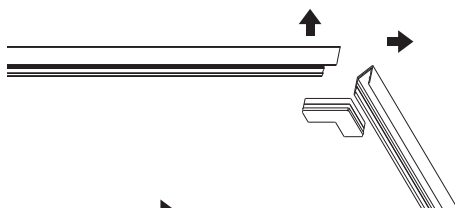

MINITRACK-033

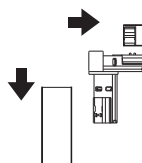

Wiring Diagram(Not limited to this):

General

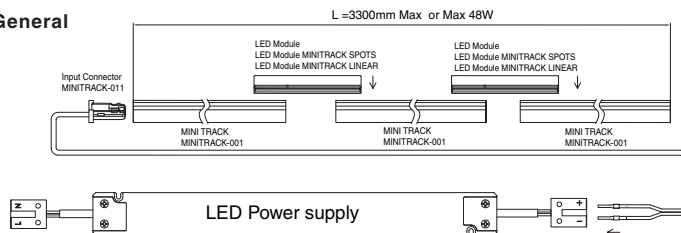

No dark area line source

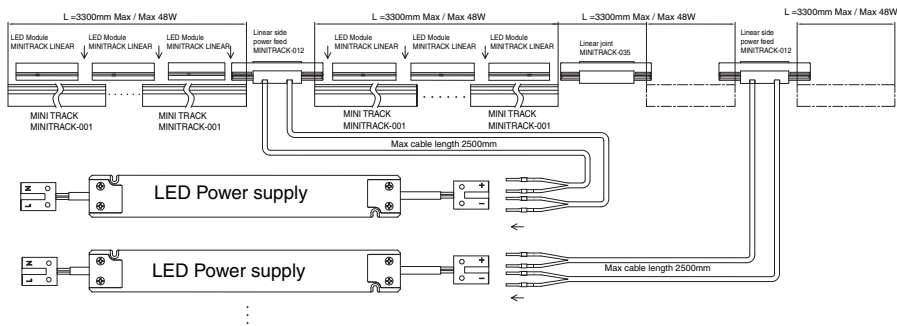

Wiring Diagram(Not limited to this):

Dimming Wiring Diagram:

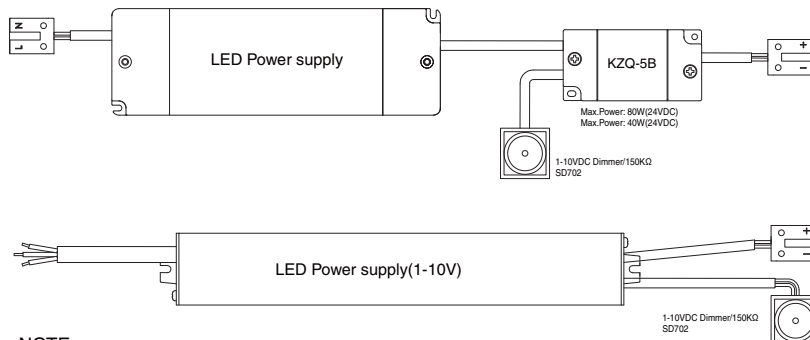

NOTE:

Grand total of luminaires Power should not exceed 80% of rated power output of LED power supply.
Only one power input for one MINI TRACK .

28/06/2023

Manufacturer

SELF ELECTRONICS CO., LTD.

Add: No. 1345 JuXian Road, Hi-Tech Park, Ningbo, China 315103

Importer

SELF ELECTRONICS GERMANY GMBH

Add: August-Horch-Str. 7, 51149 Cologne

(For European market)

SELF ELECTRONICS USA CORP.

Add: 3264 Saturn Ct, Peachtree Corners, GA 30092

(For North American market)

SELF LIGHTING TECHNOLOGY PTY., LTD.

Add: 31/3 Homelea Court, Rivervale, WA, 6103, Australia

(For Oceanian market)

SELF ELECTRONICS MIDDLE EAST DMCC

Add: Unit No. 1299, DMCC Business Centre Level No 1 Jewellery & Gemplex 3, Dubai, United Arab Emirates

(For Middle Eastern market)