

SLPU-2P2U1S-BK



ELECTRICAL

With 2 × USB-A charger ports (Rated 5Vdc, 3.1A)
USB charger built-in open circuit, short circuit, over load protection
2 × TR AC Receptacles, rated 15A, 125Vac
1x Switch, controls the rear receptacle for LED light fixtures
10' 14 AWG x 3C power cord with 5-15P plug
8" rear/side exiting cord with receptacle



MECHANICAL

Recessed mounting



CERTIFICATION

FCC compliant and UL Listed



WARRANTY

5 Years



Dimension(inches/mm)

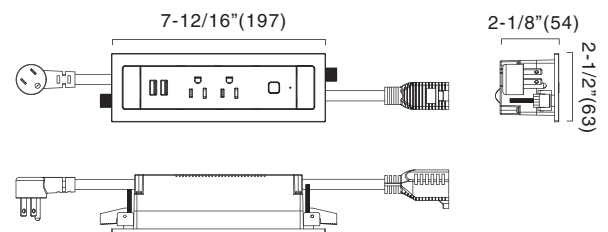

Installation

Cut hole size:
7.40"×2.09"(188mm×53mm)

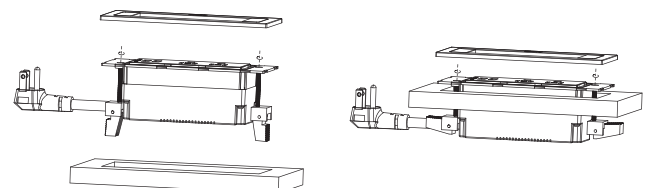

*Thickness of the board:8~35mm

SLPU-2P2U1S-WH



ELECTRICAL

With 2 × USB-A charger ports (Rated 5Vdc, 3.1A)
USB charger built-in open circuit, short circuit, over load protection
2 × TR AC Receptacles, rated 15A, 125Vac
1x Switch, controls the rear receptacle for LED light fixtures
10' 14 AWG x 3C power cord with 5-15P plug
8" rear/side exiting cord with receptacle



MECHANICAL

Recessed mounting



CERTIFICATION

FCC compliant and UL Listed



WARRANTY

5 Years



Dimension(inches/mm)

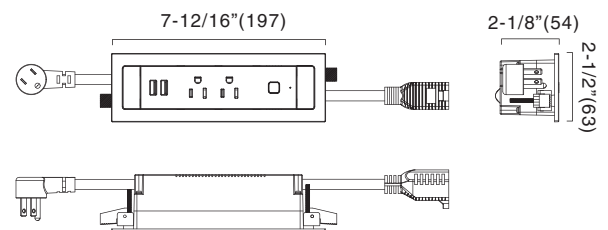

Installation

Cut hole size:
7.40"×2.09"(188mm×53mm)

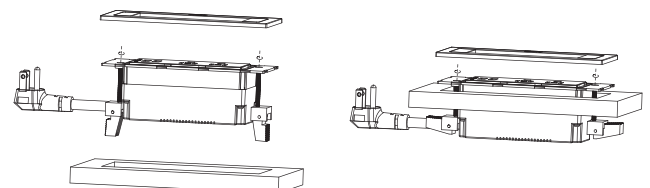

*Thickness of the board:8~35mm

SLPU-2P2U1S-NI



ELECTRICAL

With 2 × USB-A charger ports (Rated 5Vdc, 3.1A)
USB charger built-in open circuit, short circuit, over load protection
2 × TR AC Receptacles, rated 15A, 125Vac
1x Switch, controls the rear receptacle for LED light fixtures
10' 14 AWG x 3C power cord with 5-15P plug
8" rear/side exiting cord with receptacle



MECHANICAL

Recessed mounting



CERTIFICATION

FCC compliant and UL Listed



WARRANTY

5 Years



Dimension(inches/mm)

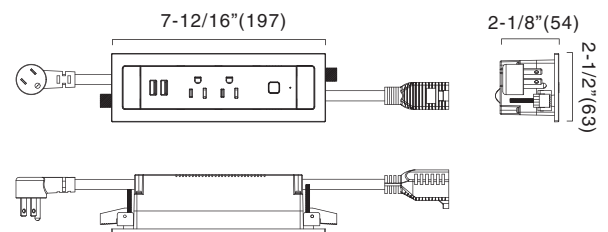

Installation

Cut hole size:
7.40"×2.09"(188mm×53mm)

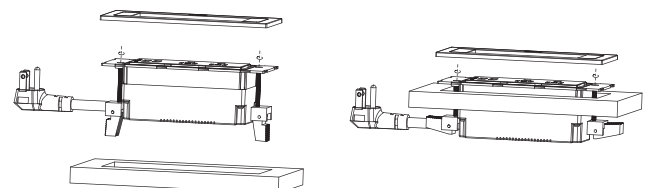

*Thickness of the board:8~35mm