

TELEP3

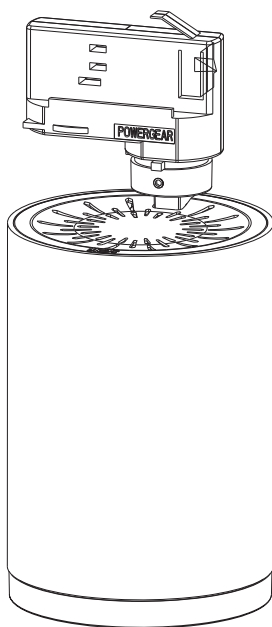

INSTRUCTION MANUAL

SERIES: TELEP3

Read these instructions completely and carefully.

ATTENTIONS

- Read the instruction carefully before installation, non-observance of this instruction may cause damage to the fixture or hurt to human body. The installation must be carried out by a qualified electrician in accordance with local or national codes.
- Cut off the power supply before installation and maintenance !
- Cut off the power supply before the electric wire connection for product first test.
- Regularly check the light source , the LED power supply, the cord and other accessories. If any part is damaged, the product should not be used.
- Keep this instruction manual handy for future use.
- The light source of these products are non-changeable light diodes(LED).
- Do not disassemble the product, as the light diode can cause damage to the eyes.
- Use only in indoor,dry location.Clean the product with a dry cloth.
- Lighting installation at a height of 2.5 meters above.

Lesen Sie diese Anweisungen vollständig und sorgfältig durch.

ACHTUNG

- Lesen Sie die Anweisungen sorgfältig vor der Installation durch. Bei Nichtbeachtung dieser Anweisung kann Schäden am Produkt oder Verletzungen am menschlichen Körper verursachen. Die Installation muss von einem qualifizierten Elektriker gemäß örtlichen oder nationalen Vorschriften durchgeführt werden.
- Schalten Sie die Stromversorgung vor der Installation und Wartung aus!
- Schalten Sie die Stromversorgung vor dem elektrischen Anschluss des Produkts für den ersten Test aus.
- Überprüfen Sie regelmäßig die Lichtquelle, das LED-Netzteil, das Kabel und andere Zubehörteile. Wenn ein Teil beschädigt ist, sollte das Produkt nicht verwendet werden.
- Bewahren Sie diese Bedienungsanleitung für zukünftige Verwendung auf.

Dimensions: (mm/inch)

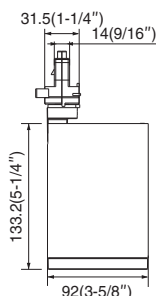

TELEP3-R1-277V

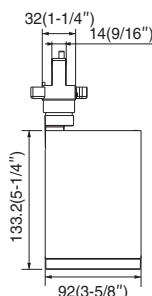
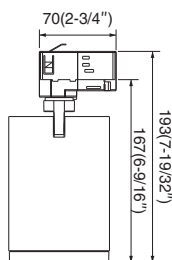

TELEP3-R1-277V-D

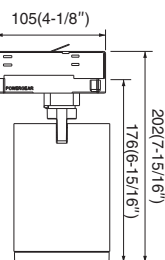

Model	Rated input	Power
TELEP3-R1-277V	120~277VAC	28W
TELEP3-R1-277V-D		

Tools



Electrical Safety Gloves



Clean cloth



Cleaning liquid
(50% ethanol)



1

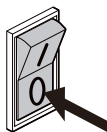

2

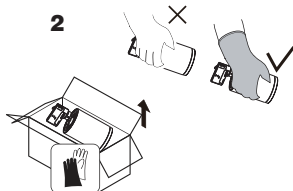

3

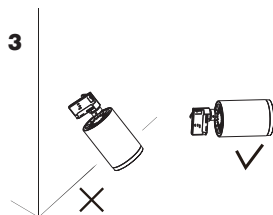

Installation

1

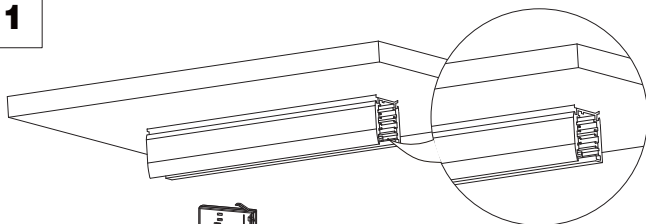

Track layout should be refer to the track installation manual.

Power knob

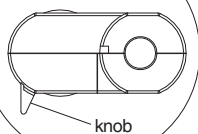

Power knob
(DALI version)
knob

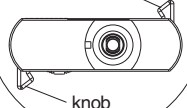

2

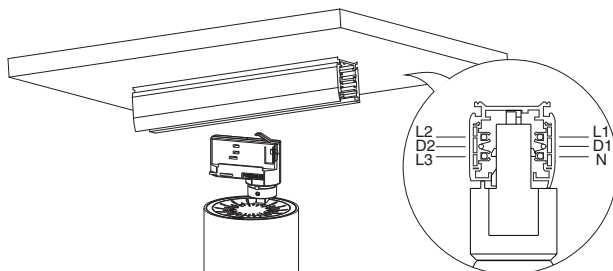

Insert the track light into the track groove. Keep the rib of the adapter with the same level of track surface.

3

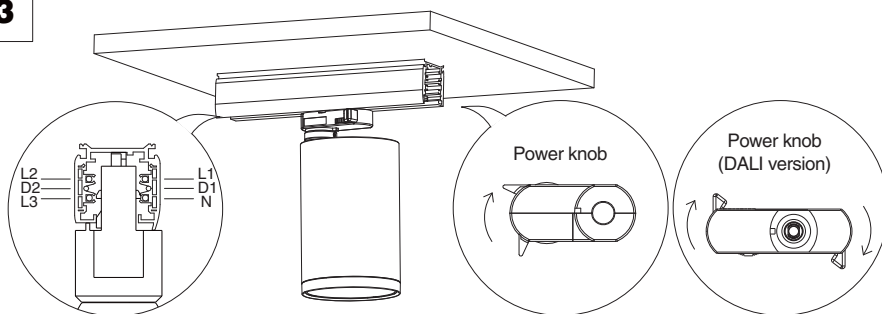

Turn the power knob anti-clockwise to lock the track.

4

Three different circuit L1,L2,L3 can be chosen by wheel

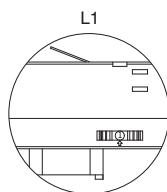

L1 circuit works

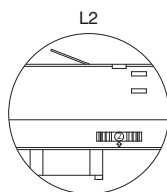

L2 circuit works

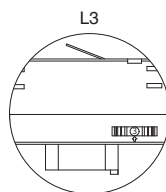

L3 circuit works

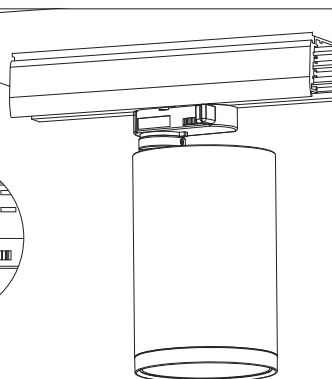

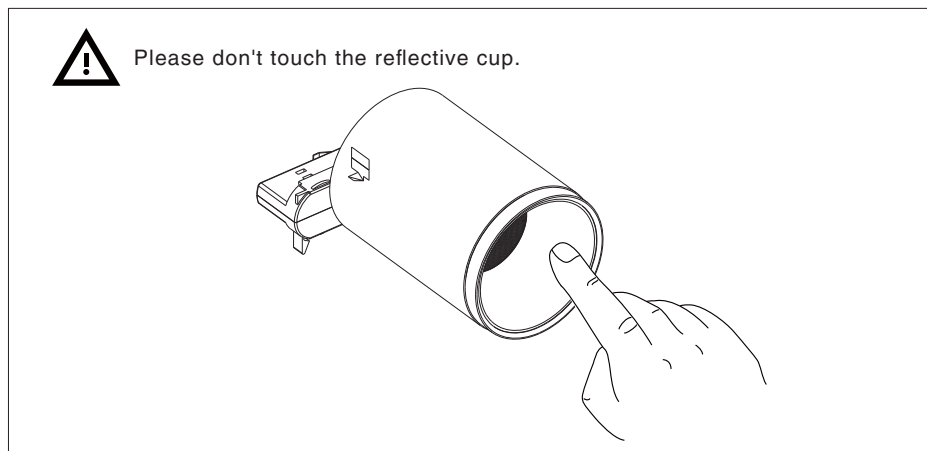
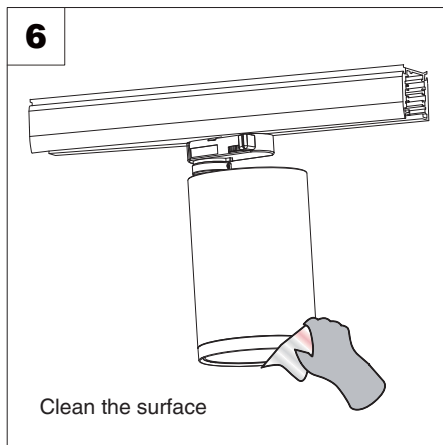
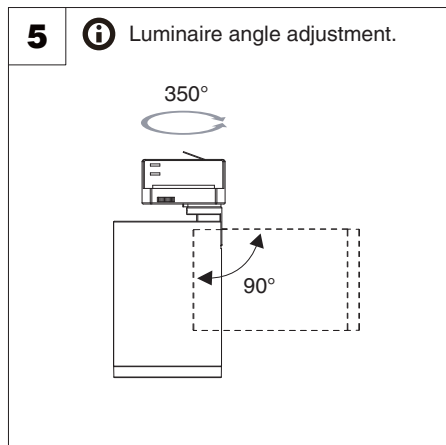

Manufacturer

SELF ELECTRONICS CO., LTD.

Add: No. 1345 JuXian Road, Hi-Tech Park, Ningbo, China 315103

Importer

SELF ELECTRONICS GERMANY GMBH

Add: August-Horch-Str. 7, 51149 Cologne

(For European market)

SELF ELECTRONICS USA CORP.

Add: 3264 Saturn Ct, Peachtree Corners, GA 30092

(For North American market)

SELF LIGHTING TECHNOLOGY PTY., LTD.

Add: 31/3 Homelea Court, Rivervale, WA, 6103, Australia

(For Oceanian market)

SELF ELECTRONICS MIDDLE EAST DMCC

Add: Unit No. 1299, DMCC Business Centre Level No 1 Jewellery & Gemplex 3, Dubai, United Arab Emirates

(For Middle Eastern market)